

# CONTENTS

## ENGINE

CYLINDER .....	B2
CRANKSHAFT-PISTON .....	B3
AIR SHROUD-FAN .....	B4
OIL PUMP .....	B5
INTAKE .....	B6
CARBURETOR .....	B7
EXHAUST .....	B8
CRANKCASE .....	B9
STARTER.....	B10
CLUTCH.....	B11
TRANSMISSION .....	B12

## CHASSIS

FRAME.....	B13
FENDER.....	B14
SIDE COVER .....	B15
OIL TANK.....	C2
REAR SUSPENSION .....	C3
FRONT FORK .....	C4

FUEL TANK .....	C5
SEAT CARRIER.....	C6
FRONT WHEEL .....	C7
FRONT BRAKE CALIPER.....	C8
REAR WHEEL .....	C9
STEERING-HANDLE-CABLE.....	C10
FRONT MASTER CYLINDER.....	C11
STAND FOOTREST.....	C12
LEG SHIELD .....	C13
COWLING .....	C14
GENERATOR.....	C15
FLASHER LIGHT .....	D2
METER .....	D3
HEADLIGHT.....	D4
TAILLIGHT .....	D5
HANDLE-SWITCH-LEVER .....	D6
ELECTRICAL 1 .....	D7
ELECTRICAL 2 .....	D8
NUMERICAL INDEX .....	M1 - M2

**YAMAHA**  
**GENUINE**  
Parts & Accessories

**CW50RSP'98 (4URD)**  
**EUROPE**

**184UR - 300E1**  
**FEBRUARY 1998**

# FOREWORD

This Part Catalogue is related to the parts in use for the **CW50RSP'98**

When you are ordering replacements parts for the **CW50RSP'98**, refer to this Parts Catalogue and quote both part numbers and part names correctly.

1. Modifications or additions which have been made after issue of the Parts Catalogue will be announced in the Parts News.

It is advisable that according to the Parts News you make necessary corrections to the Parts Catalogue on hand to keep it up-to-date.

2. Abbreviations.

The following abbreviations are used in this Parts Catalogue.

- U.R. Use size (thickness) and/or number as required.
- U.N. Use as many as you need.
- A.P. Alternate Parts.
- L.M. Local Made.
- F.≠ Frame N° (Applicable machine N°)

3. The parts marked with (\*) in the parts number column of this Catalogue are not supplied with by Yamaha, those have to be found locally.

4. Parts, which are to supplied in the form of assemblies, are listed with an indention of one letter's space, and a dot (.) is put against the name of each part.

**EXAMPLE** CARBURETOR ASS'Y  
                   .JET, pilot  
                   .NOZZLE, main

5. Indication of N° of constituent parts for assembly.

The numeral appearing to the right of each constituent part under the description indicates the quantity of such parts for each individual assembly unit.

**EXAMPLE**

Part N°	Description	Q'ty	Remarks
2F5-83310-60	FRONT FLASHER LIGHT ASS'Y	2	
115-83311-60	.BULB (6V-18W)	1	
1M1-83309-60	.REFLECTOR	1	

6. Initial Serial N° and Color Code.

(A)	Frame Serial N°	<b>4TD - 500101</b>
(B)	Engine Serial N°	<b>4SB - 000101</b>

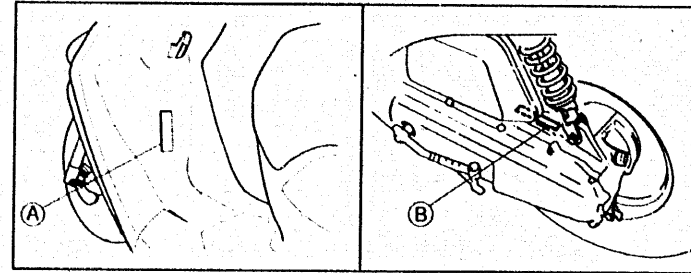

Color	Code Color	Name Abbreviate
<b>0134</b>	<b>VIVID YELLOWISH RED SOLID 1</b>	<b>VYRS1</b>
<b>004B</b>	<b>BLACK 2</b>	<b>BL2</b>

7. Applicable colors of graphics are represented in the "Remarks" column by the letter(s) appropriately picked out of the full word(s) showing such colors.

**EXAMPLE**

Part N°	Description	Q'ty	Remarks
2N4-24110-00-X5	FUEL TANK COMPL.	1	
3J1-24240-10	.GRAPHIC, fuel tank set	1	

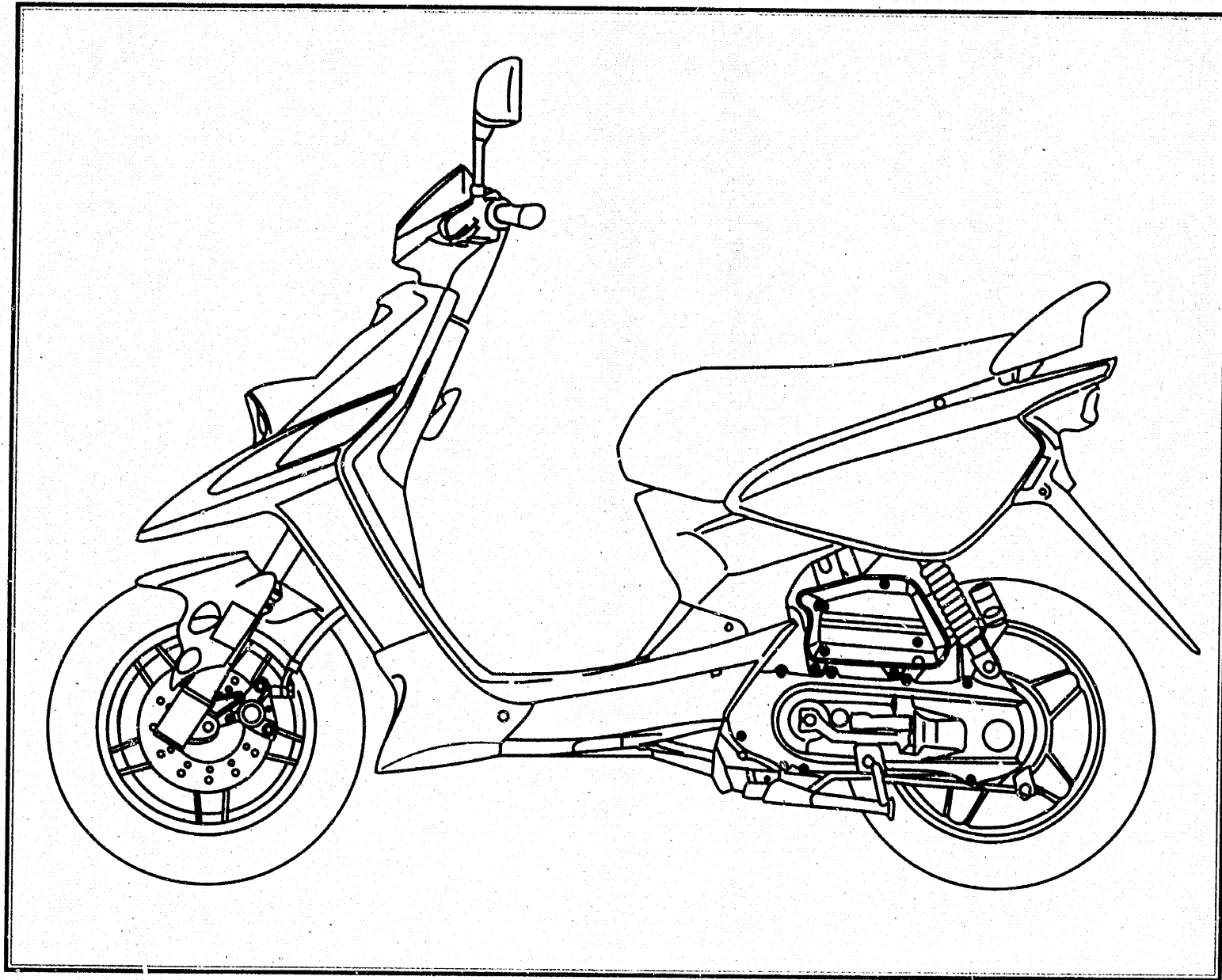

**A4**

# CONTENTS

## ENGINE

CYLINDER .....	B2
CRANKSHAFT-PISTON .....	B3
AIR SHROUD-FAN .....	B4
OIL PUMP .....	B5
INTAKE .....	B6
CARBURETOR .....	B7
EXHAUST .....	B8
CRANKCASE .....	B9
STARTER.....	B10
CLUTCH.....	B11
TRANSMISSION .....	B12

## CHASSIS

FRAME.....	B13
FENDER.....	B14
SIDE COVER .....	B15
OIL TANK.....	C2
REAR SUSPENSION .....	C3
FRONT FORK .....	C4

FUEL TANK .....	C5
SEAT CARRIER.....	C6
FRONT WHEEL .....	C7
FRONT BRAKE CALIPER .....	C8
REAR WHEEL .....	C9
STEERING-HANDLE-CABLE .....	C10
FRONT MASTER CYLINDER .....	C11
STAND FOOTREST.....	C12
LEG SHIELD .....	C13
COWLING .....	C14
GENERATOR.....	C15
FLASHER LIGHT .....	D2
METER.....	D3
HEADLIGHT.....	D4
TAILLIGHT .....	D5
HANDLE-SWITCH-LEVER .....	D6
ELECTRICAL 1 .....	D7
ELECTRICAL 2 .....	D8
NUMERICAL INDEX .....	M1 - M2

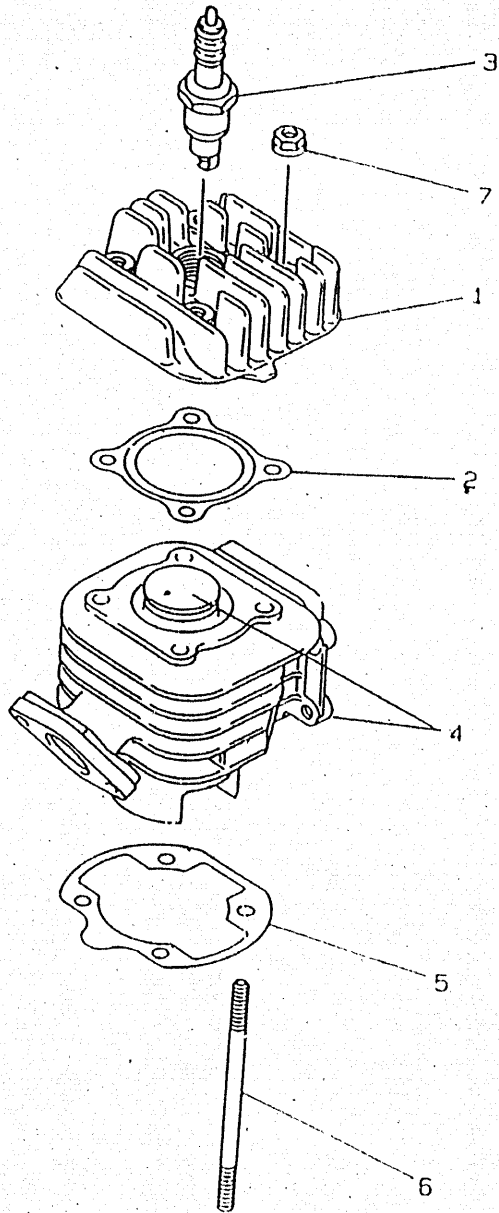

FWD

FIG 1 CYLINDER

REF	PART.N°	DESCRIPTION	QTY	REMARKS
1	4SB-E1111-00	HEAD, CYLINDER 1	1	
2	3VL-E1181-00	GASKET, CYLINDER HEAD	1	
3	94701-00195	PLUG, SPARK	1	BR8HS
4	4SB-E1311-00	CYLINDER 1	1	
	4SB-E1631-00	.PISTON (STD)	1	
	4SB-E1603-00	.PISTON RING SET (STD)	1	
	3VL-E1633-00	.PIN, PISTON	1	
	93450-11120	.CIRCLIP	2	
5	3VL-E1351-00	GASKET, CYLINDER	1	
6	90116-06418	BOLT, STUD	4	
7	95707-06500	NUT, FLANGE	4	

FIG 2 CRANKSHAFT. PISTON

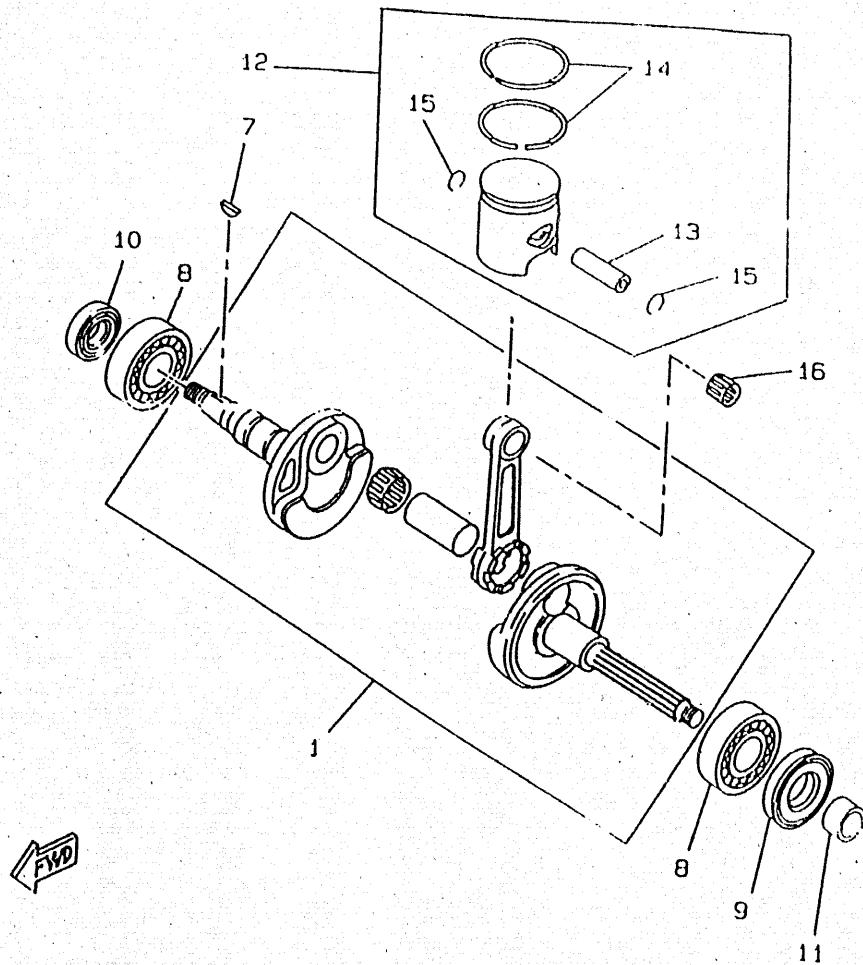

REF	PART.N°	DESCRIPTION	QTY	REMARKS
1	3VL-E1400 10	CRANKSHAFT ASSY	1	
7	90280-03017	KEY, WOODRUFF	1	
8	93306-204X2	BEARING	2	
9	93102-20371	OIL SEAL	1	
10	93101-20138	OIL SEAL	1	
11	90387-156U0	COLLAR	1	
12	4SB-E1631-00	PISTON (STD)	1	
	4SB-E1636-00	PISTON (0.50MM O/S)	1	
13	3VL-E1633-00	PIN, PISTON	1	
14	4SB-E1603-00	PISTON RING SET (STD)	1	
	4SB-E1605-00	PISTON RING SET (0.50MMO/S)	1	
15	93450-11120	CIRCLIP	2	
16	93310-210M0	BEARING, CYLINDRICAL	1	

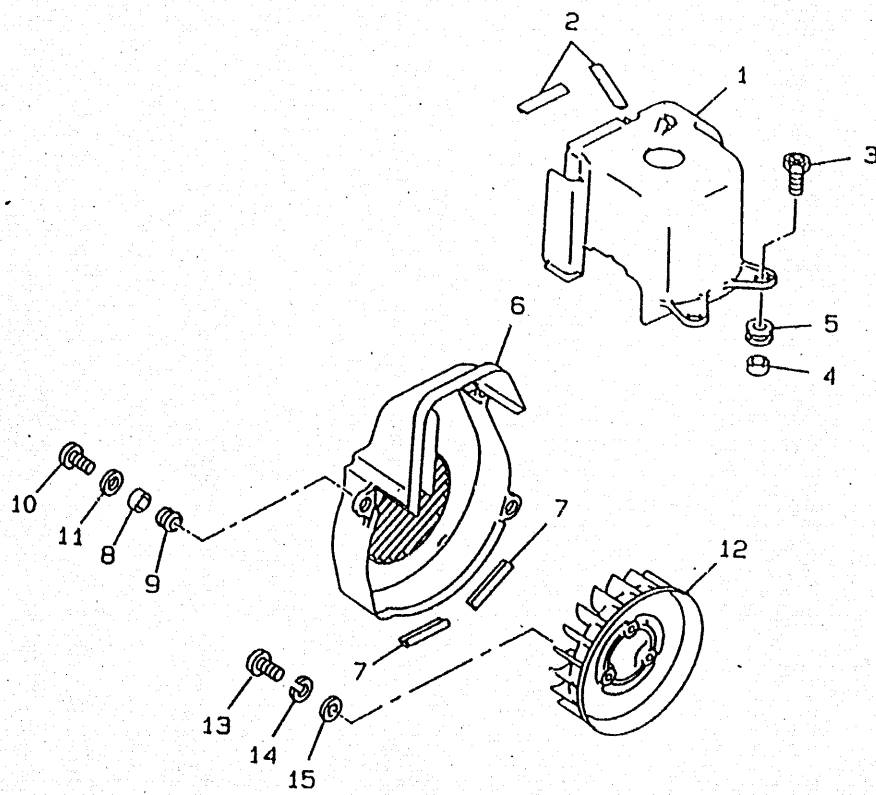

FIG 3 AIR SHROUD. FAN

REF	PART.N°	DESCRIPTION	QTY	REMARKS
1	3VL-E2651-00	AIR SHROUD, CYLINDER	1	
2	3VL-E2658-00	DAMPER, AIR SHROUD 1	2	
3	90153-06022	SCREW, HEXAGON	2	
4	90387-06023	COLLAR	2	
5	90480-12237	GROMMET	2	
6	3VL-E2653-00	AIR SHROUD, CYLINDER	1	
7	3VL-E2658-00	DAMPER, AIR SHROUD 1	2	
8	90387-06023	COLLAR	3	
9	90480-12237	GROMMET	3	
10	98517-06020	SCREW, PAN HEAD	3	
11	92907-06600	SCREW	3	
12	3VL-E2611-00	FAN	1	
13	97885-06016	SCREW, PAN HEAD	3	
14	92995-06100	WASHER	3	
15	92990-06600	WASHER, PLATE	3	



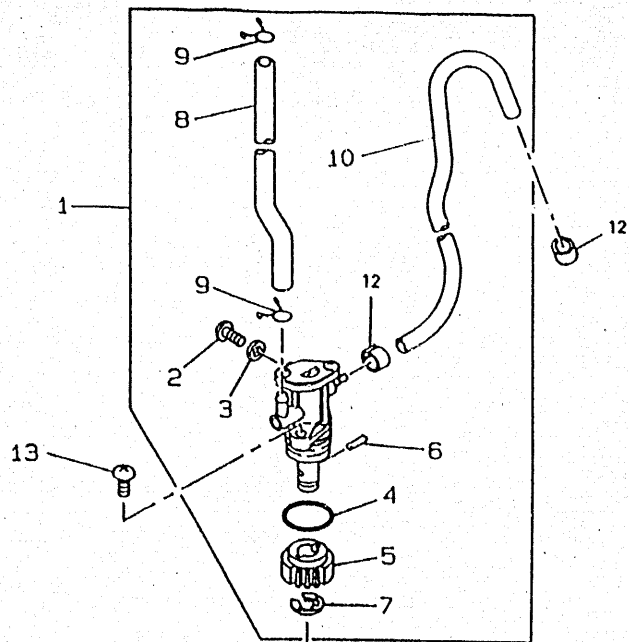
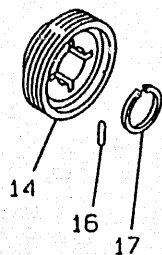

FIG 4 OIL PUMP

REF	PART.N°	DESCRIPTION	QTY	REMARKS
1	4SB-13100-00	OIL PUMP ASSY	1	
2	1YU-13185-00	.BOLT, BREATHER	1	
3	1YU-13187-00	.GASKET, BREATHER BOLT	1	
4	1YU-13473-00	.O-RING	1	
5	3AA-13124-00	.GEAR, WORM WHEEL	1	
6	1YU-13516-00	.PIN, DOWEL	1	
7	1YU-13577-00	.CLIP	1	
8	90445-094J4	.HOSE	1	
9	90468-02033	.CLIP	1	
10	1YU-13418-00	.PIPE, OIL 2	1	
12	90467-08003	.CLIP	2	
13	98507-05014	SCREW	2	
14	3VL-E3178-00	GEAR, PUMP DRIVE	1	
16	93603-12007	PIN, DOWEL	1	
17	99009-19400	CIRCLIP	2	



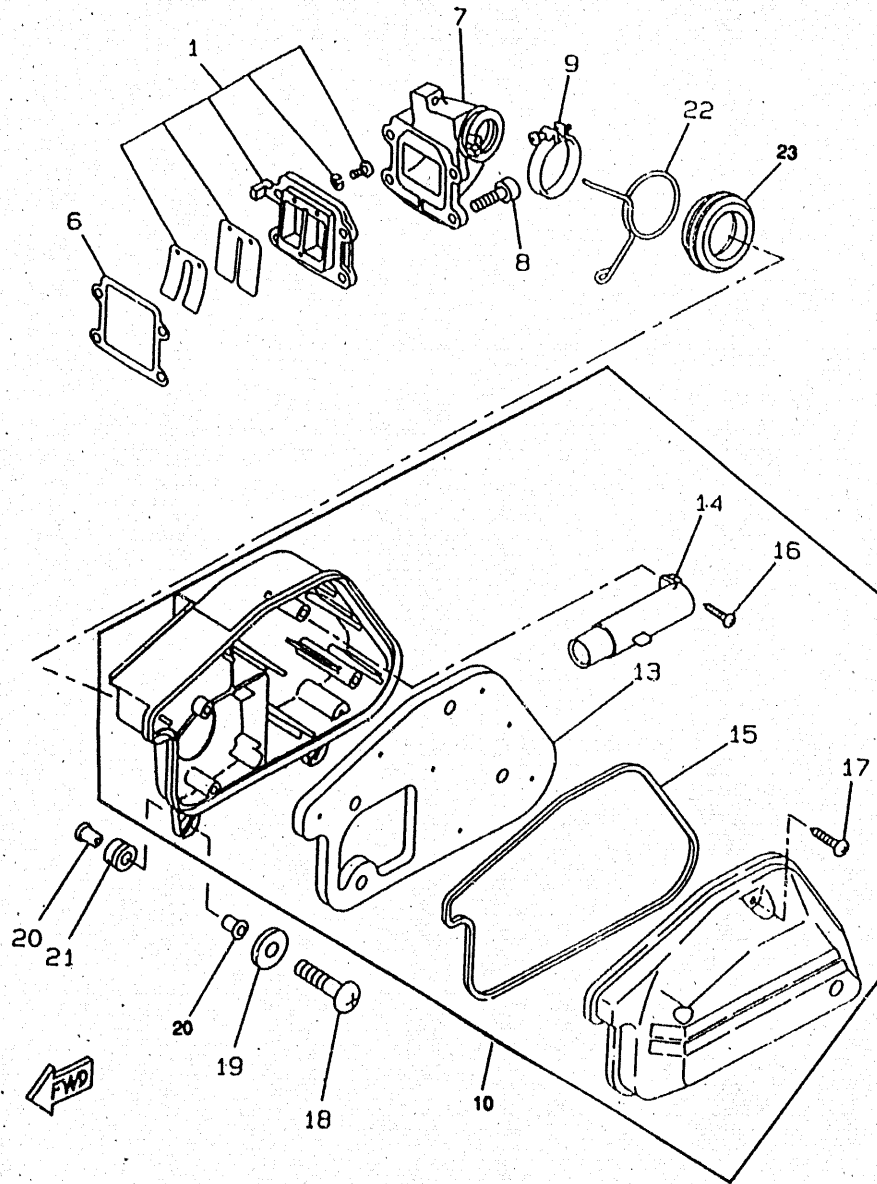

FIG 5 INTAKE

REF	PART.N°	DESCRIPTION	QTY	REMARKS
1	3VL E3610 00	REED VALVE ASSY	1	
6	4KN-13621-00	GASKET, VALVE SEAT	1	
7	3VL E3555 00	MANIFOLD, INTAKE	1	
8	91317-06020	BOLT	4	
9	90450-32081	HOSE CLAMP ASSY	1	
10	3VL E4410 01	AIR CLEANER ASSY.	1	
13	3VL E4451 00	ELEMENT, AIR CLEANER	1	
14	3VL E4437 00	DUCT	1	
15	3VL E4452 00	SEAL	1	
16	3VL E4429 00	SCREW	1	
17	3VL E4565 00	SCREW	4	
18	98517-06025	SCREW	2	
19	92907-06600	SCREW	2	
20	90387-061V4	COLLAR	4	
21	90480-12497	GROMMET	2	
22	90467-24140	CLIP	1	
23	3VL E4453 01	JOINT, AIR CLEANER 1	1	

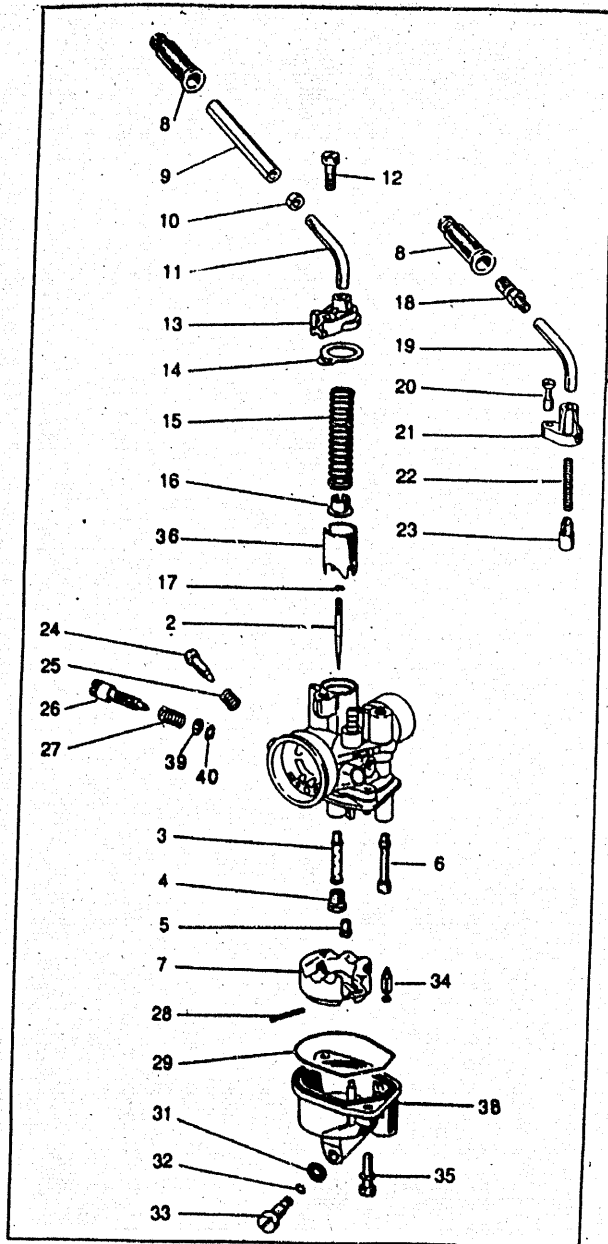
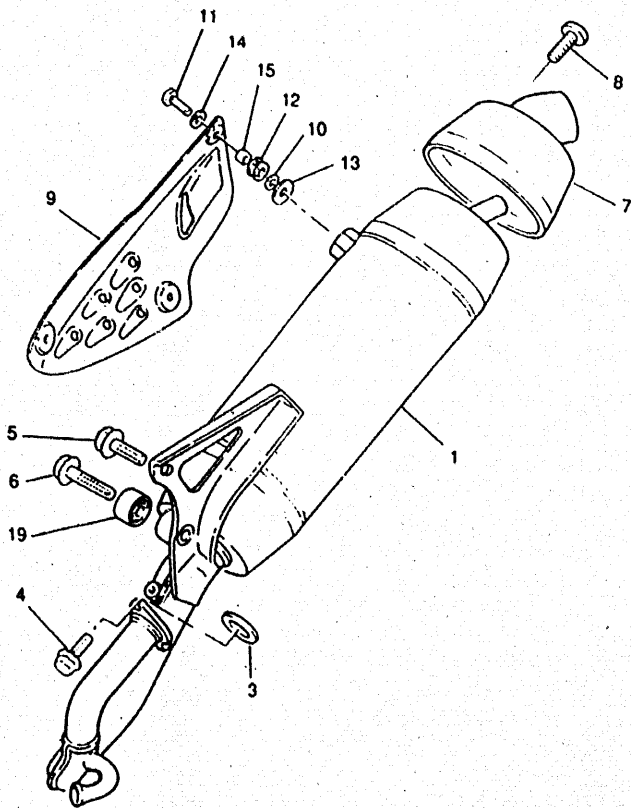

FIG 6 CARBURETOR

REF	PART.N°	DESCRIPTION	QTY	REMARKS
1	4SB-E4301-01	CARBURETOR ASSY 1	1	
2	5BR-E4336-00	.NEEDLE	1	
3	4SB-E4341-00	.NOZZLE, MAIN	1	
4	4SB-E4343-00	.JET, MAIN	1	
5	4SR-E4342-00	.JET, PILOT	1	
6	4SB-E4344-01	.JET, STARTER	1	
7	4SB-E4385-00	.FLOAT	1	
8	4SB-F6329-00	.CAP, RUBBER	2	
9	5BR-E4161-00	.NUT, CABLE ADJUSTING	1	
10	5BR-E4358-00	.NUT	1	
11	4SB-E4148-01	.PIPE	1	
12	5BR-E4325-00	.SCREW, PAN HEAD	1	
13	5BR-E4369-00	.DIAPHRAGM ASSY 2	1	
14		IN GASKET KIT REP 37		
15	4SB-E4331-02	.SPRING, THROTTLE VALVE	1	
16	4SB-E4377-00	.STOPPER	1	
17	4SB-E4137-00	.CLIP	1	
18	4SB-E4124-00	.SCREW, CABLE ADJUSTING	1	
19	4SB-E4318-00	.PIPE STARTER	1	
20	4SB-E4216-00	.SCREW	1	
21	4SB-E4368-01	.DIAPHRAGM ASSY 1	1	
22	4SB-E4335-00	.SPRING, PLUNGER	1	
23	4SB-E4371-00	.PLUNGER, STARTER	1	
24	4SB-E4104-00	.AIR SCREW SET	1	
25	4SB-E4134-00	.SPRING, AIR ADJUSTING	1	
26	4SB-E4103-01	.THROTTLE SCREW SET	1	
27	4SB-E4133-01	.SPRING, THROTTLE STOP	1	
28	4SB-E4386-00	.PIN, FLOAT	1	
29		IN GASKET KIT REP 37		
31		IN GASKET KIT REP 37		
32		IN GASKET KIT REP 37		
33	4SB-E4115-00	.PLUG, SCREW	1	
34	4SB-E4392-00	.VALVE, NEEDLE	1	
35	4SB-E4216-10	.SCREW	1	
36	4SB-E4312-02	.VALVE, THROTTLE 1	1	
37	4SB-W0001-00	.GASKET KIT	1	
38	4SB-E4381-00	.BODY, FLOAT CHAMBER	1	
39	4SB-E4357-00	.WASHER, PLAIN	1	
40		IN GASKET KIT REP 37		
41	4SB-E4283-01	COVER, CARBURETOR 1	1	



FWD

FIG 7 EXHAUST

REF	PART.N°	DESCRIPTION	QTY	REMARKS
1	4SB E4610 00	EXHAUST PIPE ASSY 1	1	
3	3HK-14613-00	GASKET, EXHAUST PIPE	1	
4	90153-06061	SCREW, HEXAGON	2	
5	95817-08020	BOLT, FLANGE	1	
6	95817-08040	BOLT, FLANGE	1	
7	4SB-E479X-00	PIPE TAIL ASSY	1	CHROME
8	4SB-E4678-00	BOLT, COUPLING	1	
9	4SB-E4718-00	PROTECTOR, MUFFLER 1	1	ALU
10	4SB-E4759-00	WASHER	3	
11	98904-06016	SCREW, BIND	3	
12	90387-060G7	COLLAR	3	
13	4FB-14766-00	WASHER, PROTECTOR	3	
14	3HK-14766-01	WASHER, PROTECTOR	3	
15	90480-12581	GROMMET	3	
19	2JA-14737-00	DAMPER, MUFFLER	1	

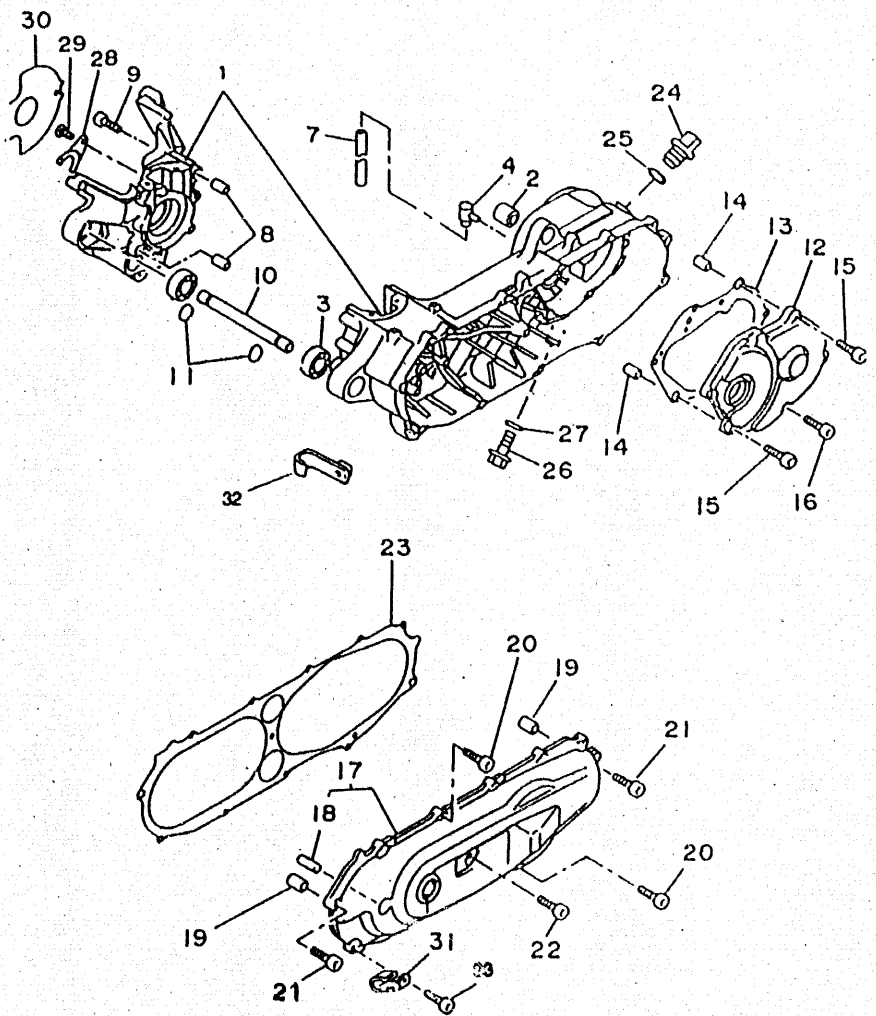

FIG 8 CRANKCASE

REF	PART.N°	DESCRIPTION	QTY	REMARKS
1	3VL-E5150-00	CRANKCASE ASSY	1	
2	164-22216-00	BUSH, REAR SHOCK ABS	1	
3	93306-00201	BEARING (B6002)	2	
4	3VL-E5371-00	BREATHER	1	
7	90446-13311	HOSE	1	
8	99510-12016	PIN, DOWEL	2	
9	90110-06237	BOLT, HEXAGON SOCKET HEAD	6	
10	3VL-E5317-00	SPACER, ENGINE MOUNT	1	
11	99009-15400	CIRCLIP	2	
12	3VL-E5421-00	COVER, CRANKCASE 2	1	
13	3VL-E5461-00	GASKET, CRANKCASE	1	
14	99530-10014	PIN, DOWEL	2	
15	90110-06237	BOLT, HEXAGON SOCKET HEAD	2	
16	91317-06020	BOLT	4	
17	3VL-E5411-00	COVER, CRANKCASE 1	1	
18	3VL-E5659-00	SHAFT	1	
19	99530-10014	PIN, DOWEL	2	
20	90110-06240	BOLT	8	
21	90110-06237	BOLT, HEXAGON SOCKET HEAD	2	
22	91317-06045	BOLT	1	
23	3VL-E5451-00	GASKET, CRANKCASE	1	
24	3VL-E5363-00	PLUG, OIL	1	
25	93210-14104	O-RING	1	
26	95817-08016	BOLT, FLANGE	1	
27	90430-08206	GASKET	1	
28	3VL-E5128-00	HOLDER	1	
29	98517-06012	SCREW, PAN HEAD	1	
30	3VL-E5462-00	GASKET, CRANKCASE	1	
31	90465-08122	CLAMP	1	
32	4SB-F1238-00	BRACKET	1	
33	90110-06825	BOLT, HEXAGON SOCKET HEAD	1	

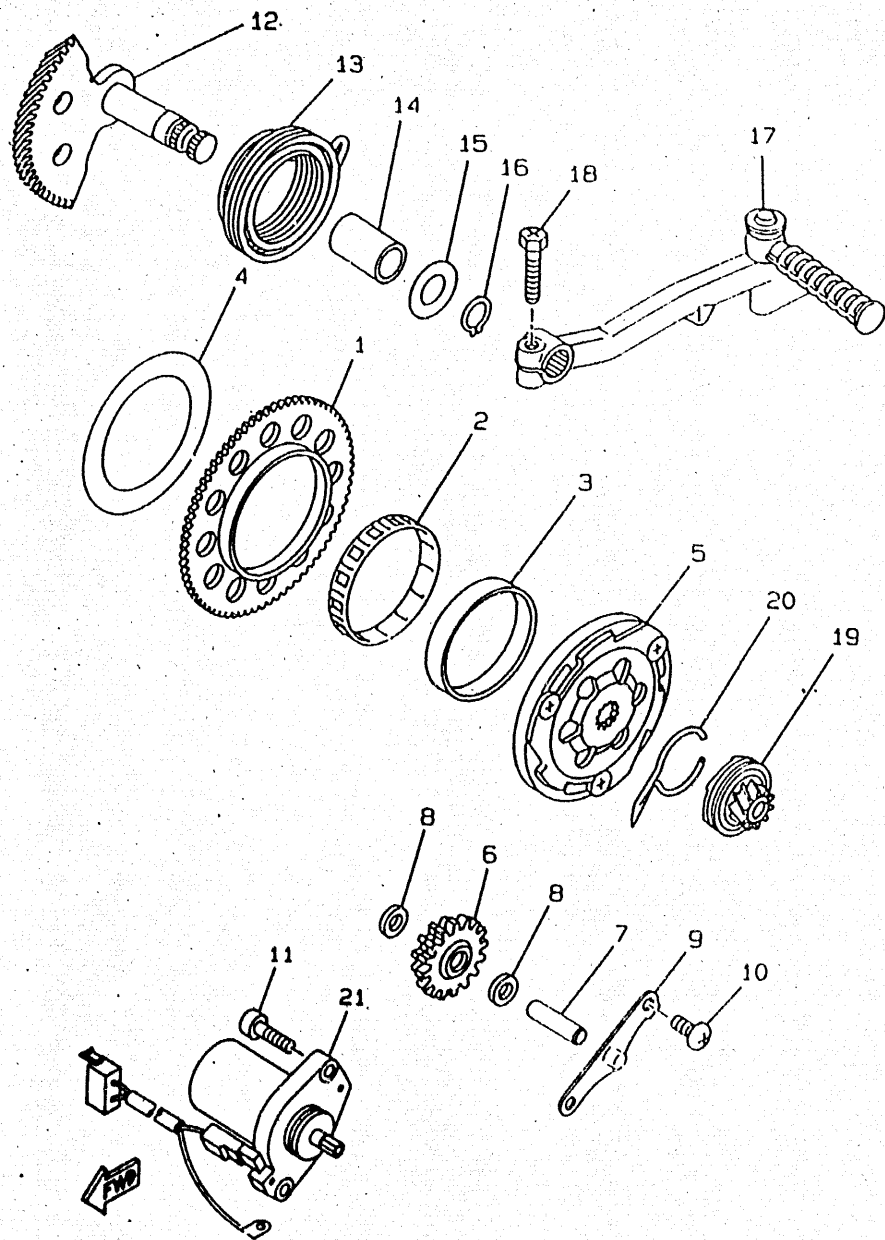

FIG 9 STARTER

REF	PART.N°	DESCRIPTION	QTY	REMARKS
1	3AA-15513-00	GEAR 1	1	
2	93310-257R1	BEARING, CYLINDRICAL	1	
3	3VL E5528-00	BOSS, GEAR	1	
4	90201-574L1	WASHER, PLATE	1	
5	3VL-15570-00	STARTER CLUTCH ASSY	1	
6	4SB-E5650-00	IDLE GEAR ASSY	1	
7	3VL-E5659-00	SHAFT	1	
8	90201-08X00	WASHER, PLAIN	2	
9	3VL E5532-00	PLATE, IDLE GEAR	1	
10	98517-06012	SCREW, PAN HEAD	2	
11	91317-06020	BOLT	2	
12	3ES-15601-01	KICK SHAFT ACSY	1	
13	90508-32609	SPRING, TORSION	1	
14	90380-15083	BUSH, SOLID	1	
15	90201-154E9	WASHER, PLAIN	1	
16	99009-15400	CIRCLIP	1	
17	3VL-E5620-01	KICK CRANK ASSY	1	
18	90101-06X01	BOLT	1	
19	4SB-E5631-00	GEAR, KICK PINION	1	
20	3VL-E5673-00	CLIP	1	
21	4SB-H1800-00	STARTING MOTOR ASSY	1	

Y3FC010-8090

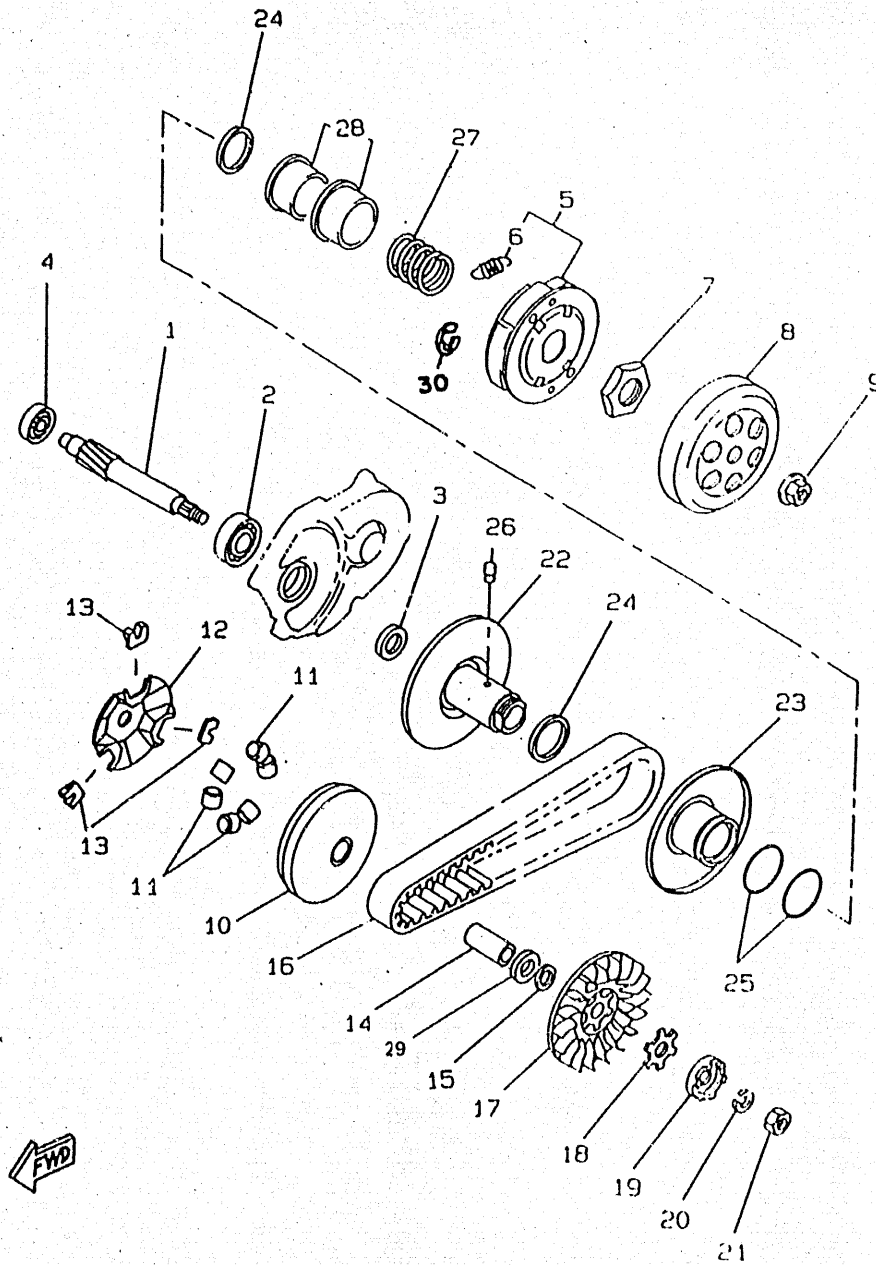

FIG 10 CLUTCH

REF	PART.N°	DESCRIPTION	QTY	REMARKS
1	3VL-E6111-00	GEAR, PRIMARY DRIVE	1	
2	93306 20301	BEARING	1	
3	93102 17342	OIL SEAL	1	
4	93306-20006	BEARING (B6200)	1	
5	5BR-E6620-00	CLUTCH CARRIER ASSY	1	
6	5BR-E6626-00	SPRING, CLUTCH WEIGHT 1	3	
7	90170 28860	NUT	1	
8	5BR-E6611-00	CLUTCH HOUSING COMP.	1	
9	90179-10609	NUT	1	
10	4CU-E7620-00	PRIMARY SLIDING SHEAVE COMP.	1	
11	4KH-E7632-00	WEIGHT	6	
12	3VL-E7623-00	CAM	1	
13	3VL-E7653-00	SLIDER	3	
14	90387-135U9	COLLAR	1	
15	90201-133M8	WASHER, PLATE	1	
16	3AA-17641-00	V-BELT	1	
17	3VL-E7611-00	SHEAVE, PRIMARY FIXE	1	
18	90214-13055	WASHER,CLAW (0.5T)	1	
19	3KJ-15657-00	CLUTCH, ONEWAY	1	
20	90208-10012	WASHER, CONICAL SPRING	1	
21	90170-10219	NUT	1	
22	5BR-E7660-00	SECONDARY FIXED SHEAVE COMP.	1	
23	5BR-E7671-00	SECONDARY SLIDING SHEAVE	1	
24	93104-34832	OIL SEAL	2	
25	93210-368E7	O-RING	2	
26	5BR-E7664-00	PIN, GUIDE	2	
27	90501-35864	SPRING, COMPRESSION	1	
28	5BR-E7684-00	SEAT, SECONDARY SPRING	1	
29	4SB-E7654-00	SPACER 1	1	
30	93001-05600	CIRCLIP	3	

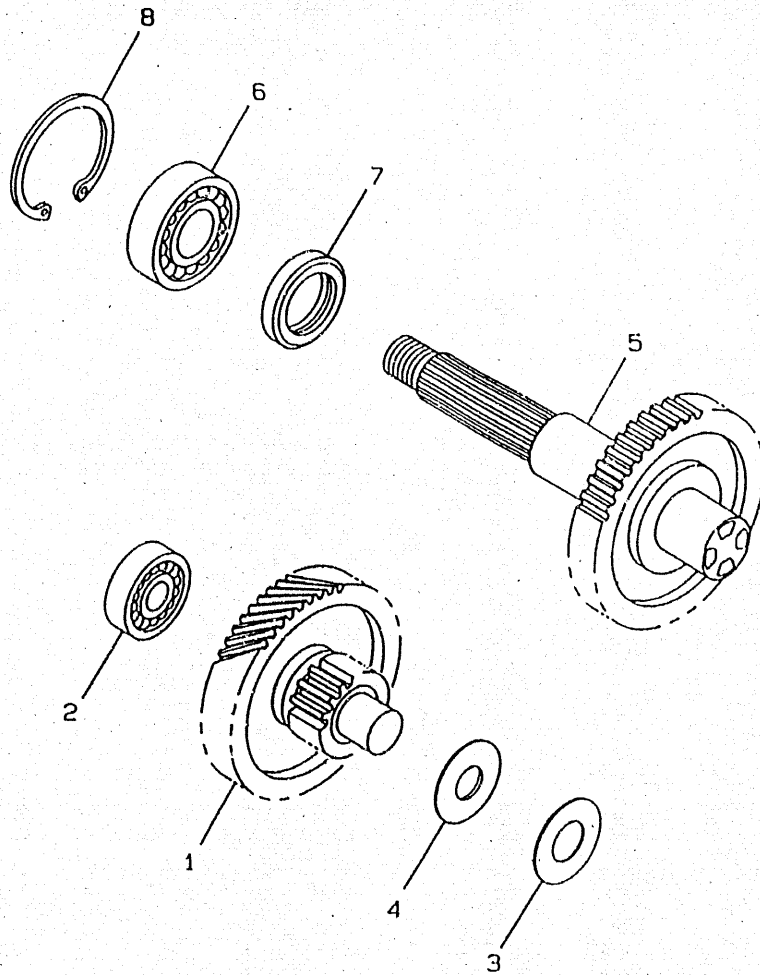

FIG 11 TRANSMISSION

REF	PART.N°	DESCRIPTION	QTY	REMARKS
1	4SB E7410-00	MAIN AXLE COMP.	1	
2	93306-20006	BEARING (B6200)	1	
3	90201-140G5	WASHER, PLATE	1	
4	90208-14047	WASHER, CONICAL SPRI	1	
5	4SB-E7420-00	DRIVE AXLE ASSY	1	
6	93306-20310	BEARING (B6203)	1	
7	93102-22314	OIL SEAL	1	
8	93420-40064	CIRCLIP	1	





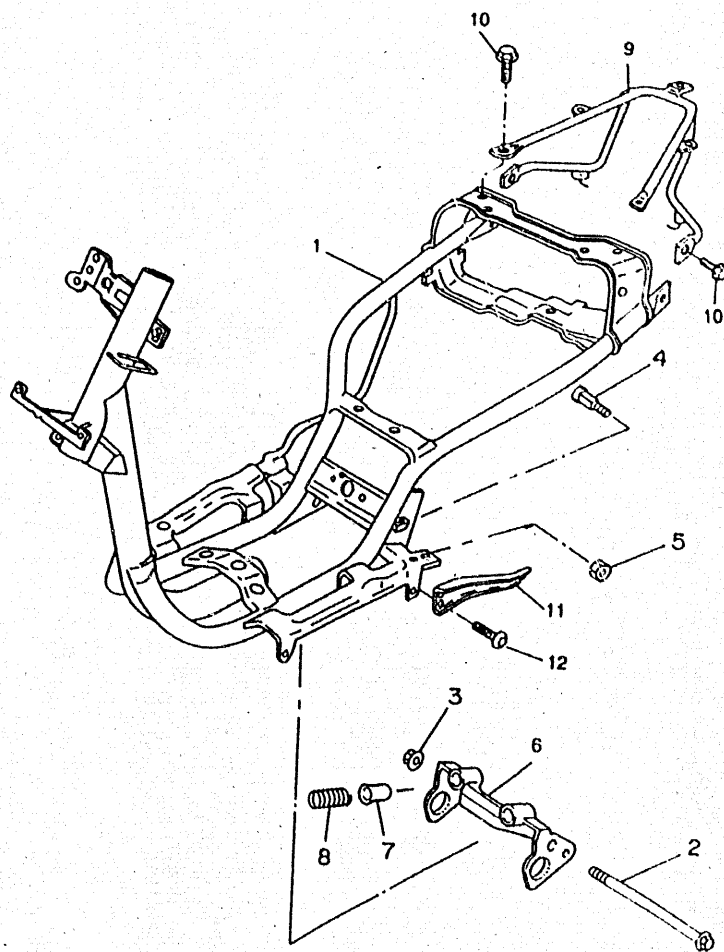
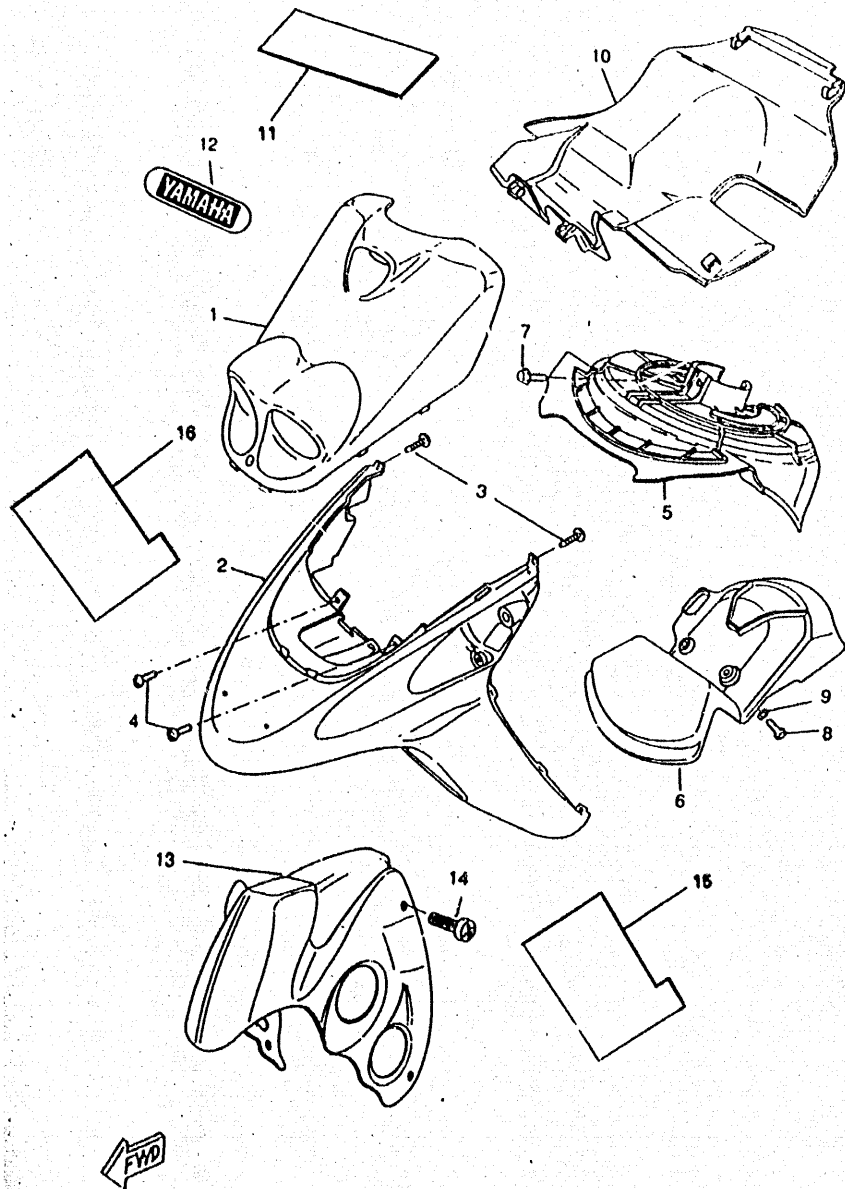

FIG 12 FRAME

REF	PART.N°	DESCRIPTION	QTY	REMARKS
1	4YB-F1110-12	FRAME COMP.	1	UR YAMAHA BLACK
2	90105-10297	BOLT, WASHER BASED	1	
3	90179-10279	NUT, POP	1	
4	2T4-21481-01	BOLT, ENGINE MOUNTIN	2	
5	95617-10100	BOLT, STUD	2	
6	3VL F1410 11	ENGINE BRACKET COMP.	1	UR YAMAHA BLACK
7	2T4-2139X-00	DAMPER	2	
8	90501-29517	SPRING, COMPRESSION	1	
9	4SB F1232-00	REINFORCEMENT, TAIL	1	UR YAMAHA BLACK
10	95817-08016	BOLT, FLANGE	4	
11	4SB-F7452-00	BRACKET, FOOTREST 1	1	
12	92017-08016	BOLT	2	
	4UP-F1182-00	NOT ILLUSTRED MANUFACTURER PLATE	1	
	90267-32801	RIVET, BLIND	2	

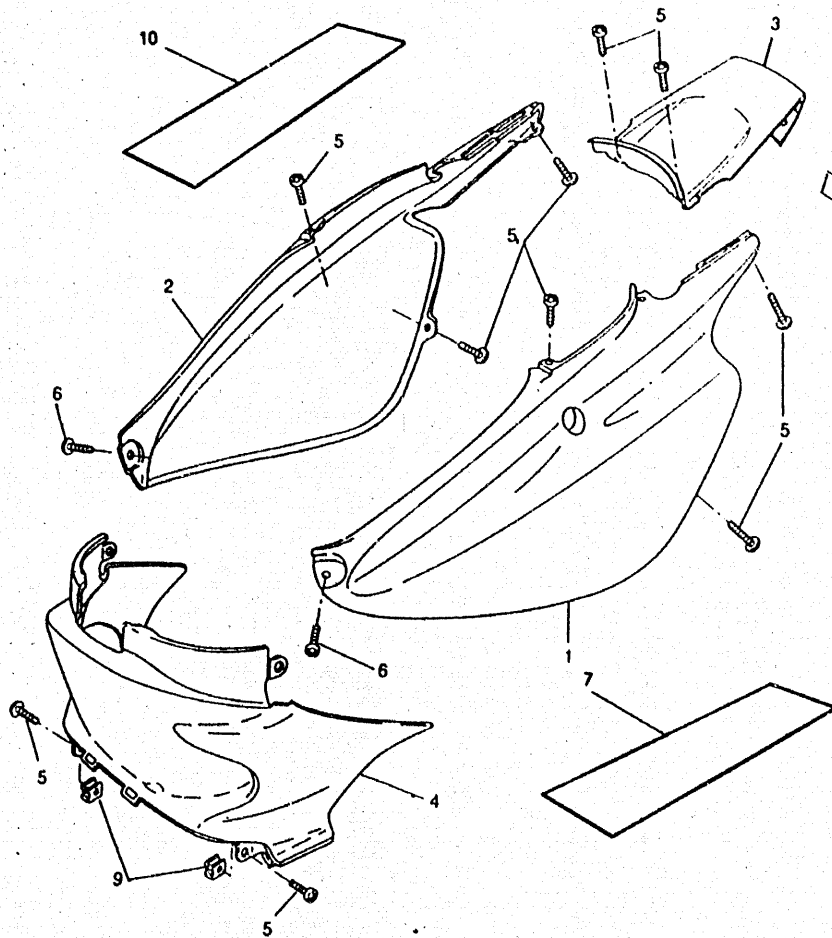

FIG 13 FENDER



REF	PART.N°	DESCRIPTION	QTY	REMARKS
1	4SB-F1511-00-4B	FENDER, FRONT	1	UR BLACK 2
	4SB-F1511-00-PB	FENDER, FRONT	1	UR VIVID YELLOWISH RED SOLID1
2	4UP-F1519-00	MOLD, FENDER	1	UR BL2
	4UP-F1519-60	MOLD, FENDER	1	UR VYRS1
3	97707-50016	SCREW, TAPPING	2	
4	98907-06016	SCREW, BIND	2	
5	4SB-F1552-01	FENDER, INNER	1	UR BLACK
6	4SB-F1553-00	FENDER, INNER 2	1	UR BLACK
7	95817-06010	BOLT, FLANGE	1	
8	90119-06052	BOLT, WITH WASHER	2	
9	92907-06600	SCREW	2	
10	4SB-F1629-01	GUARD, MUD	1	UR BLACK
11	4WK-F1565-00	EMBLEM 2	1	UR BL2
	4WK-F1565-10	EMBLEM 2	1	UR VYRS1
12	4UP-F152A-10	EMBLEM 3	1	UR VYRS1
	4UP-F152A-20	EMBLEM 3	1	UR BL2
13	4UP-F1556-00-4B	FENDER, FRONT 2	1	UR BLACK 2
	4UP-F1556-00-P1	FENDER, FRONT 2	1	UR VIVID YELLOWISH RED SOLID1
14	4UP-F1531-00	BOLT	4	
15	4WK-F1569-00	GRAPHIC 1	1	BL2
	4WK-F1569-10	GRAPHIC 1	1	VYRS1
16	4WK-F1579-00	GRAPHIC 2	1	BL2
	4WK-F1579-10	GRAPHIC 2	1	VYRS1
		NOT ILLUSTRED		
	3EC-H5111-00	REFLECTOR, FRONT 1	2	

FIG 14 SIDE COVER



REF	PART.N°	DESCRIPTION	QTY	REMARKS
1	4SB-F1721-00-4B	COVER, SIDE 2	1	UR BLACK 2
	4SB-F1721-00-PB	COVER, SIDE 2	1	UR VIVID YELLOWISH RED SOLID1
2	4SB F1731-00-4B	COVER, SIDE 3	1	UR BLACK 2
	4SB F1731-00-PB	COVER, SIDE 3	1	UR VIVID YELLOWISH RED SOLID1
3	4SB F171E-00-4B	COVER, SIDE 5	1	UR BLACK 2
	4SB F171E-00-PB	COVER, SIDE 5	1	UR VIVID YELLOWISH RED SOLID1
4	4SB-F1711-00	COVER, SIDE 1	1	UR BLACK
5	97707-50016	SCREW, TAPPING	10	
6	97707-50012	SCREW, TAPPING	2	
7	4WK F173E-00	GRAPHIC 1	1	UR BL2
	4WK F173E-10	GRAPHIC 1	1	UR VYRS1
8	4UP-F152A-10	EMBLEM 3	1	UR VYRS1
	4UP-F152A-20	EMBLEM 3	1	UR BL2
9	90183-05042	NUT, SPRING	2	
10	4WK F173F-00	GRAPHIC 2	1	UR BL2
	4WK F173F-10	GRAPHIC 2	1	UR VYRS1

FYD

# CONTENTS

## ENGINE

CYLINDER .....	B2
CRANKSHAFT-PISTON .....	B3
AIR SHROUD-FAN .....	B4
OIL PUMP .....	B5
INTAKE .....	B6
CARBURETOR .....	B7
EXHAUST .....	B8
CRANKCASE .....	B9
STARTER.....	B10
CLUTCH.....	B11
TRANSMISSION .....	B12

## CHASSIS

FRAME.....	B13
FENDER.....	B14
SIDE COVER .....	B15
OIL TANK.....	C2
REAR SUSPENSION .....	C3
FRONT FORK .....	C4

FUEL TANK .....	C5
SEAT CARRIER.....	C6
FRONT WHEEL .....	C7
FRONT BRAKE CALIPER .....	C8
REAR WHEEL .....	C9
STEERING-HANDLE-CABLE .....	C10
FRONT MASTER CYLINDER .....	C11
STAND FOOTREST .....	C12
LEG SHIELD .....	C13
COWLING .....	C14
GENERATOR.....	C15
FLASHER LIGHT .....	D2
METER .....	D3
HEADLIGHT .....	D4
TAILLIGHT .....	D5
HANDLE-SWITCH-LEVER .....	D6
ELECTRICAL 1 .....	D7
ELECTRICAL 2 .....	D8
NUMERICAL INDEX .....	M1 - M2

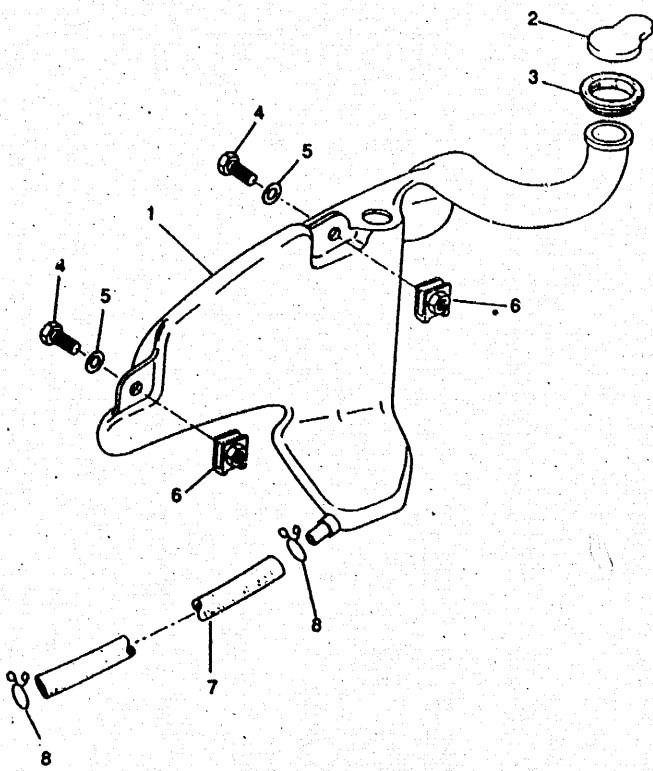

FIG 15 OIL TANK

REF	PART.N°	DESCRIPTION	QTY	REMARKS
1	4SB-F1751-00	TANK, OIL	1	
2	2N3-21771-01	BODY, CAP	1	
3	4SB-F414E-00	SEAL 2	1	
4	90119-06044	BOLT, WITH WASHER	2	
5	90201-065F3	WASHER, PLAIN	2	
6	25G-21535-00	NUT 1	3	
7	90445-094J4	HOSE	1	
8	90468-02033	CLIP	2	
		NOT ILLUSTRATED		
	4SB-H2141-00	LABEL, BATTERY	1	
	4SB-F174X-10	DAMPER	2	

← FWD

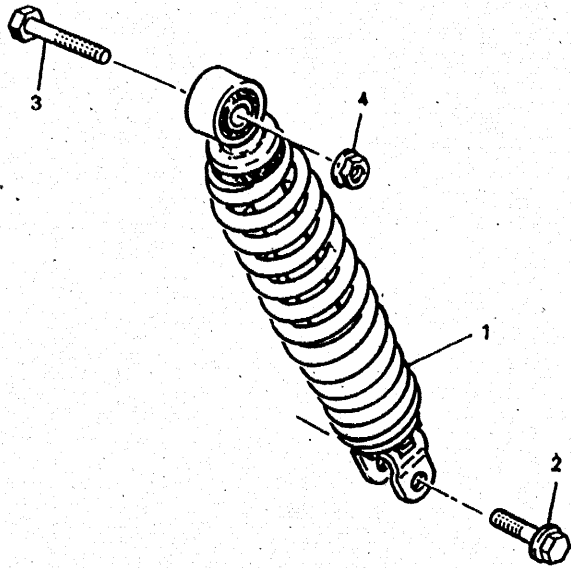

FIG 16 REAR SUSPENSION

REF	PART.N°	DESCRIPTION	QTY	REMARKS
1	4SB-F2210-00	SHOCK ABSORBER ASSY, REAR	1	
2	90105-08121	BOLT, WASHER BASED	1	
3	90101-10776	BOLT	1	
4	95617-10200	BOLT, STUD	1	

FWD

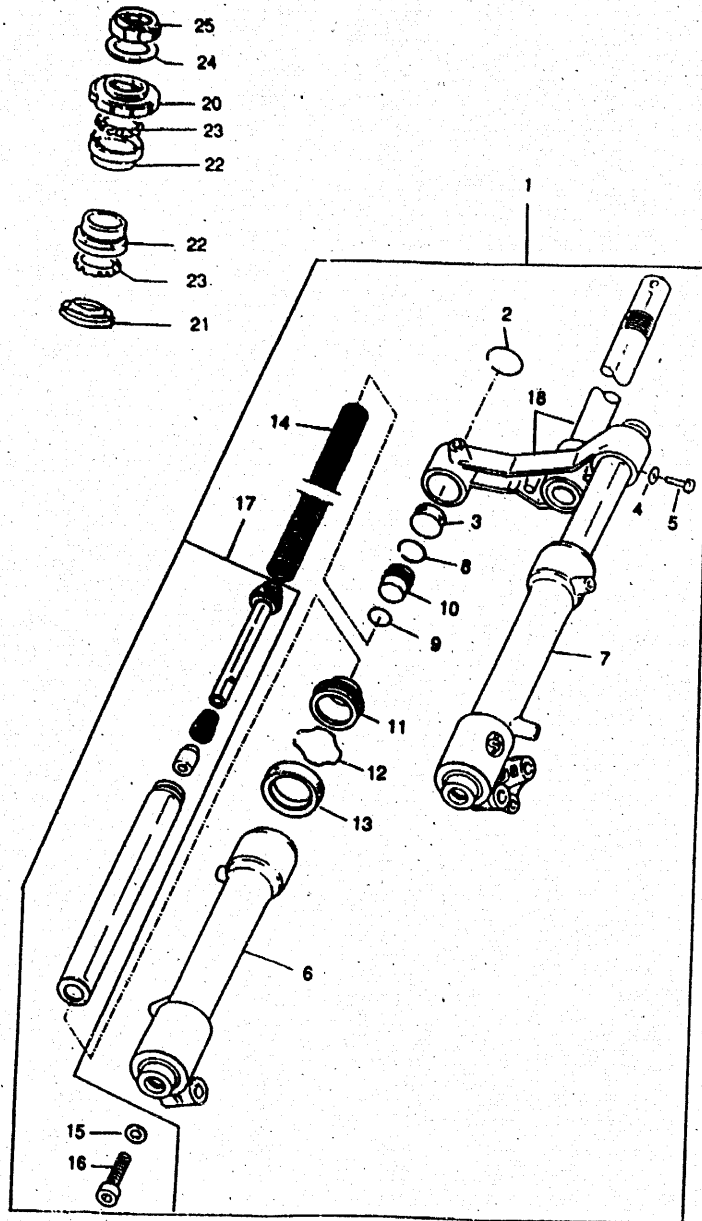
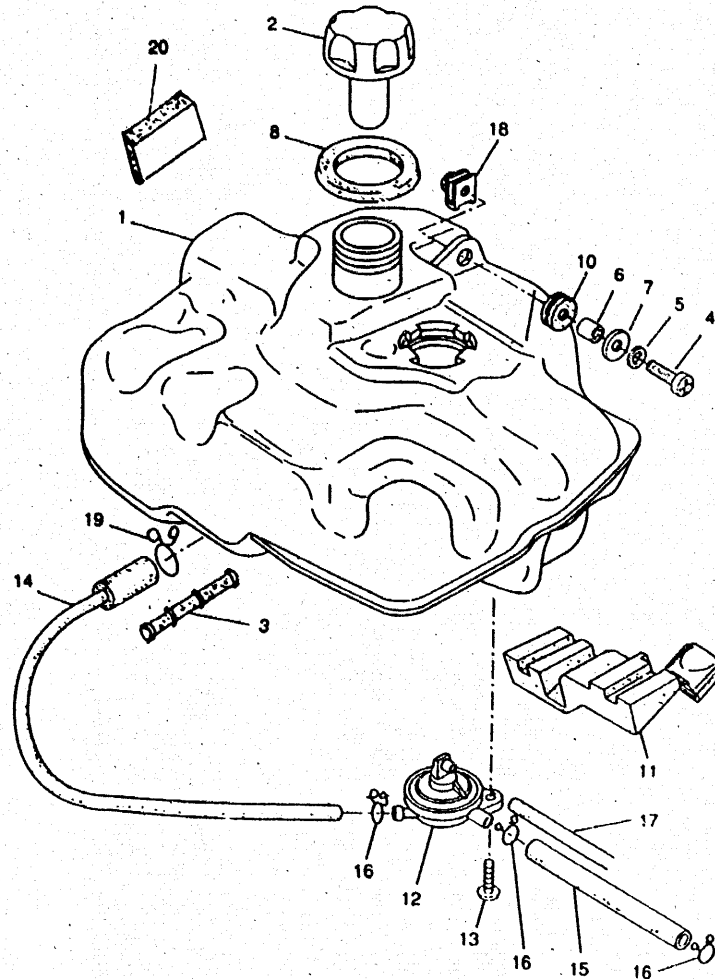

FIG 17 FRONT FORK

REF	PART.N°	DESCRIPTION	QTY	REMARKS
1	4UP-F3100-01	FRONT FORK ASSY	1	
2	4TD-F3153-00	.RING, SNAP	2	
3	4TD-F3154-00	.PLUG, INNER TUBE	2	
4	4TD-F3112-00	.WASHER, CAP	2	
5	4TD-F3394-00	.BOLT, SPECIAL	2	
6	4UP-F3136-00	.TUBE, OUTER 2 RIGHT	1	
7	4UP-F3126-00	.TUBE, OUTER 1 LEFT	1	
8	4TD-F3183-00	.CIRCLIP	2	
9	4TD-F3147-00	.O-RING	2	
10	4TD-F3111-00	.BOLT, CAP	2	
11	4TD-F3144-00	.SEAL, DUST	2	
12	4TD-F3156-00	.CLIP, OIL SEAL	2	
13	4TD-F3145-00	.OIL SEAL	2	
14	4TD-F3141-00	.SPRING, FRONT FORK	2	
15	4CU-F3165-00	.WASHER PLAIN	2	
16	4TD-F3181-00	.BOLT, HEXAGON SOCKET HEAD	2	
17	4TD-F3110-00	.INNER TUBE COMP.1	1	
18	4TD-F3340-01	.UNDER BRACKET COMP.	1	
20	4SB-F3411-01	RACE, BALL 1	1	
21	4SB-F3414-00	RACE, BALL 4	1	
22	4SB-F3412-00	RACE, BALL 2	2	
23	4SB-F3812-00	PLANE BEARING, STEERING	2	
24	4SB-F3427-01	WASHER	1	
25	4SB-F3453-01	NUT, FITTING 1	1	

FIG 18 FUEL TANK



REF	PART.N°	DESCRIPTION	QTY	REMARKS
1	4SB-F4110-00	FUEL TANK COMP.	1	
2	4MJ-F4610-00	CAP ASSY	1	
3	4SB-F4451-01	NET, FILTER	1	
4	98507-06020	SCREW	1	
5	92907-06600	SCREW	1	
6	90387-060G7	COLLAR	1	
7	90201-065F3	WASHER, PLAIN	1	
8	4SB-F414G-00	SEAL	1	
10	90480-13398	GROMMET	1	
11	4SB-F4181-00	DAMPER, LOCATING 1	1	
12	4SB-F4500-00	FUEL COCK A: SY 1	1	
13	97707-60016	SCREW, TAPPING	1	
14	4SB-F4311-01	PIPE, FUEL 1	1	
15	4SB-F4312-00	PIPE 2	1	
16	90467-09006	CLIP	3	
17	4SB-F4335-00	PIPE, SUCTION 1	1	
18	25G-21535-00	NUT 1	1	
19	90467-12052	CLIP	1	
20	4SB-F174X-10	DAMPER	1	





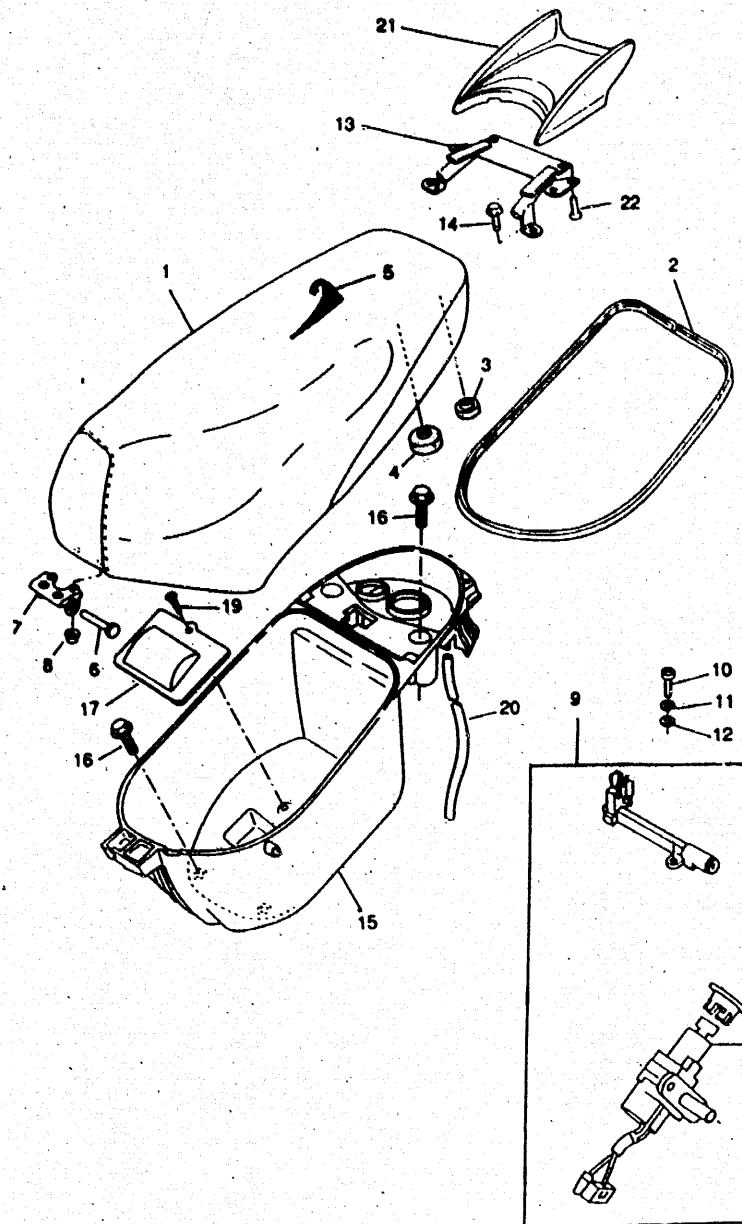
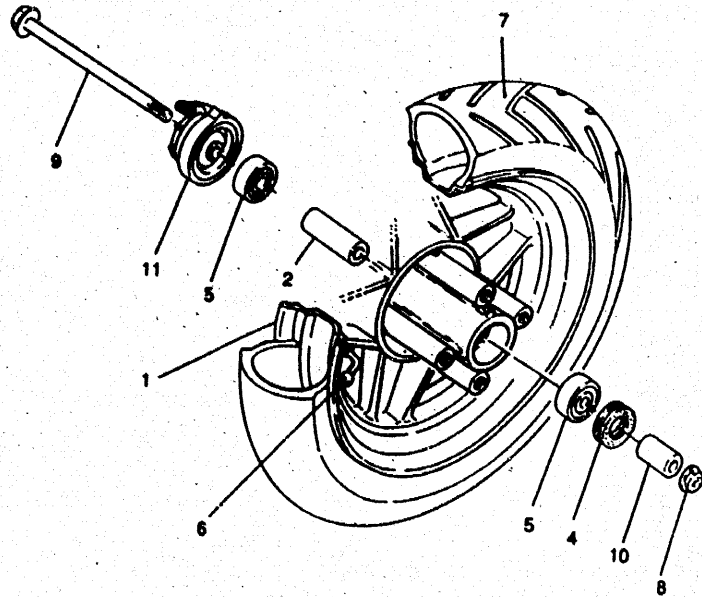

FIG 19 SEAT. CARRIER

REF	PART.N°	DESCRIPTION	QTY	REMARKS
1	4SB-F4730-00	DOUBLE SEAT ASSY	1	BLACK
2	4SB-F475M-00	.SEAL	1	
3	3VL-F4741-00	.PAD, SEAT	2	
4	3VL-F4741-10	.PAD, SEAT	2	
5	4SB-F4731-00	COVER, SEAT	1	BLACK
6	90241-10017	PIN	1	
7	4CU-F4726-00	HINGE, SEAT	1	
8	95707-06500	NUT, FLANGE	2	
9	4SB-H2021-02	KEY SET	1	
10	98507-06020	SCREW	2	
11	92907-06100	SCREW	2	
12	92907-06600	SCREW	2	
13	4UP-F1165-00	HANDLE, STANDING	1	UR YAMAHA BLACK
14	95027-08016	BOLT FLANGE	2	
15	4SB-F473R-01	BOX 1	1	
16	90109-063F1	BOLT	4	
17	4SB-F473T-00	LID 1	1	
19	97707-50016	SCREW, TAPPING	1	
20	4SB-F4318-00	PIPE, OVERFLOW	1	
21	4UP-F4812-01-4B	HANDLE	1	UR BLACK 2
	4UP-F4812-01-P1	HANDLE	1	UR VIVID YELLOWISH RED SOLID1
22	4UP-F1631-00	BOLT 1	4	



FIG 20 FRONT WHEEL



REF	PART.N°	DESCRIPTION	QTY	REMARKS
1	4UP-F5168-30	CAST WHEEL, FRONT	1	UR BL2
	4UP-F5168-40	CAST WHEEL, FRONT	1	UR VVRS1
2	4SB-F5117-00	SPACER, BEARING	1	
4	93106-20001	OIL SEAL	1	
5	93306-30010	BEARING	2	
6	3VL-F5170-10	AIR VALVE ASSY	1	
7	94112-128P5	TIRE	1	120/70-12 PIRELLI
	94112-128R9	TIRE	1	120/70-12 HUTCHINSON
8	95617-10200	BOLT, STUD	1	
9	486-22141-01	SHAFT, PIVOT	1	
10	90387-10079	COLLAR	2	
11	4VV-F5190-00	GEAR UNIT ASSY	1	
	4VV-F5138-00	NOT ILLUSTRATED GEAR, METER	1	

FWD

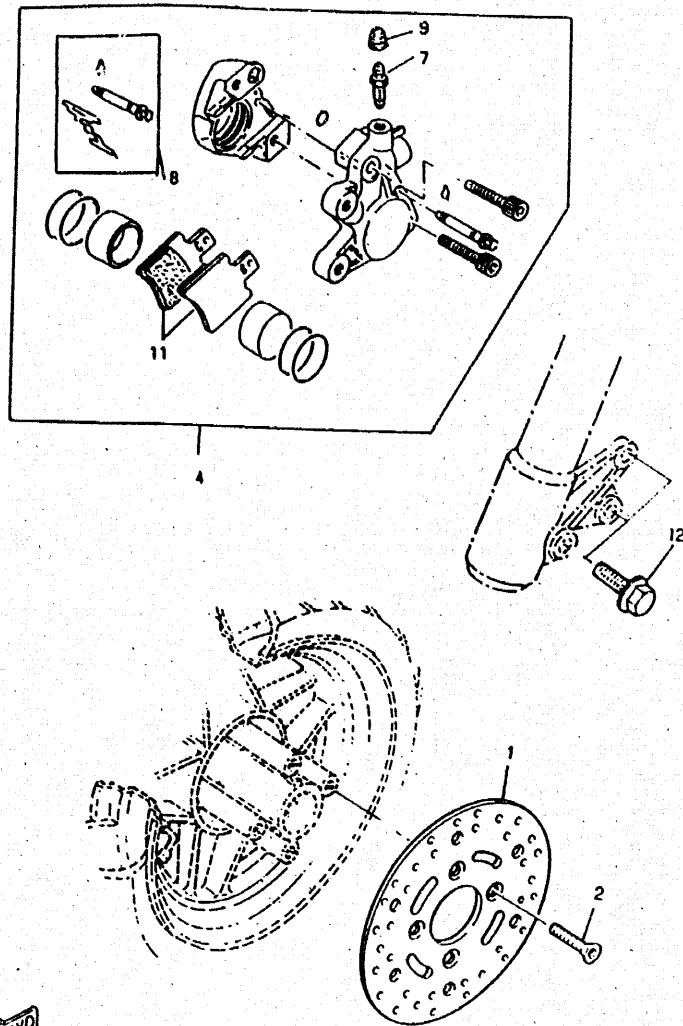
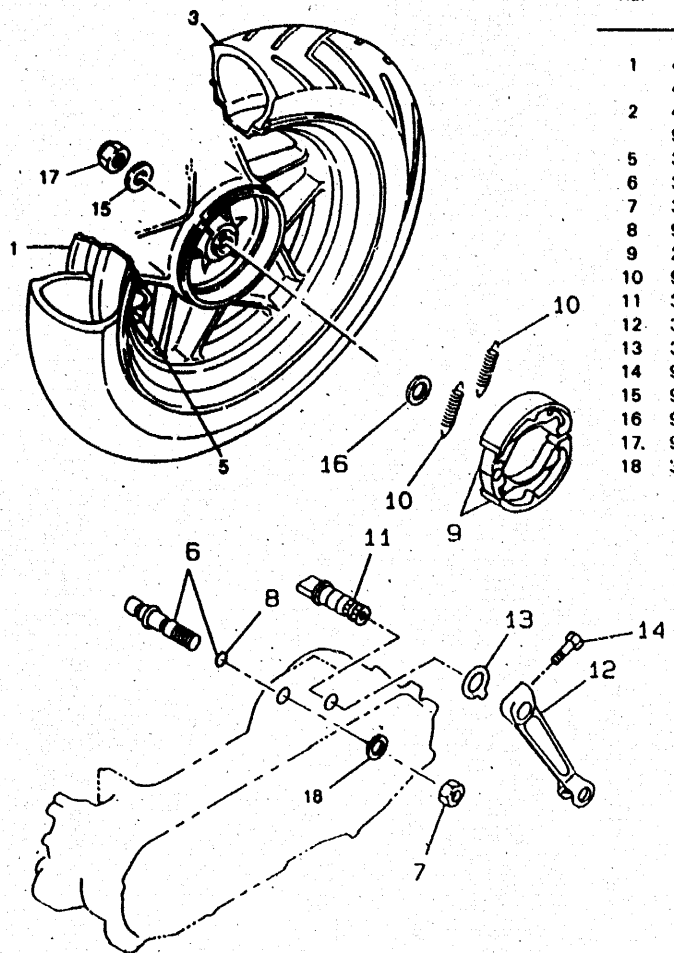

FIG 21 FRONT BRAKE CALIPER

REF	PART.N°	DESCRIPTION	QTY	REMARKS
1	4SB-2582T-00	DISC, BRAKE	1	
2	90110-10223	BOLT, HEXAGON SOCKET HEAD	4	
4	4CU-F580T-20	CALIPER ASSY (LEFT)	1	
7	4CU-F5824-00	.SCREW, BREED	1	
8	4CU-F5919-00	.SUPPORT, PAD ASSY	1	
9	4CU-F5825-00	.CAP	1	
11	4CU-F5811-20	.PAD, CALIPER 2	2	
12	95817-08030	BOLT, FLANGE	2	

FIG 22 REAR WHEEL



REF	PART.N°	DESCRIPTION	QTY	REMARKS
1	4UP-F5338-30	CAST WHEEL, REAR	1	UR BL2
	4UP-F5338-40	CAST WHEEL, REAR	1	UR VYRS1
2	4UP-M5308-00	TIRE	1	130/70-12 PIRELLI
	94113-128S0	TIRE	1	130/70-12 HUTCHINSON
5	3VL-F5170-10	AIR VALVE ASSY	1	
6	3VL-F5328-00	PIN, PIVOT	1	
7	3VL-F5182-00	NUT, AXLE	1	
8	93210-07540	O-RING	1	
9	2JL-W2536-10	BRAKE SHOE SET	1	
10	90506-15260	SPRING	2	
11	3AA-25351-00	CAMSHAFT	1	
12	3VL-F5355-00	LEVER, CAMSHAFT	1	
13	3Y6-2533A-01	PLATE, INDICATOR	1	
14	90101-06291	BOLT (L:130MM)	1	
15	90201-142M6	WASHER, PLATE	1	
16	90201-177G4	WASHER, PLAIN	1	
17	90185-14070	NUT, SELF-LOCKING	1	
18	3VL-F5384-00	WASHER, WHEEL	1	

← FWD

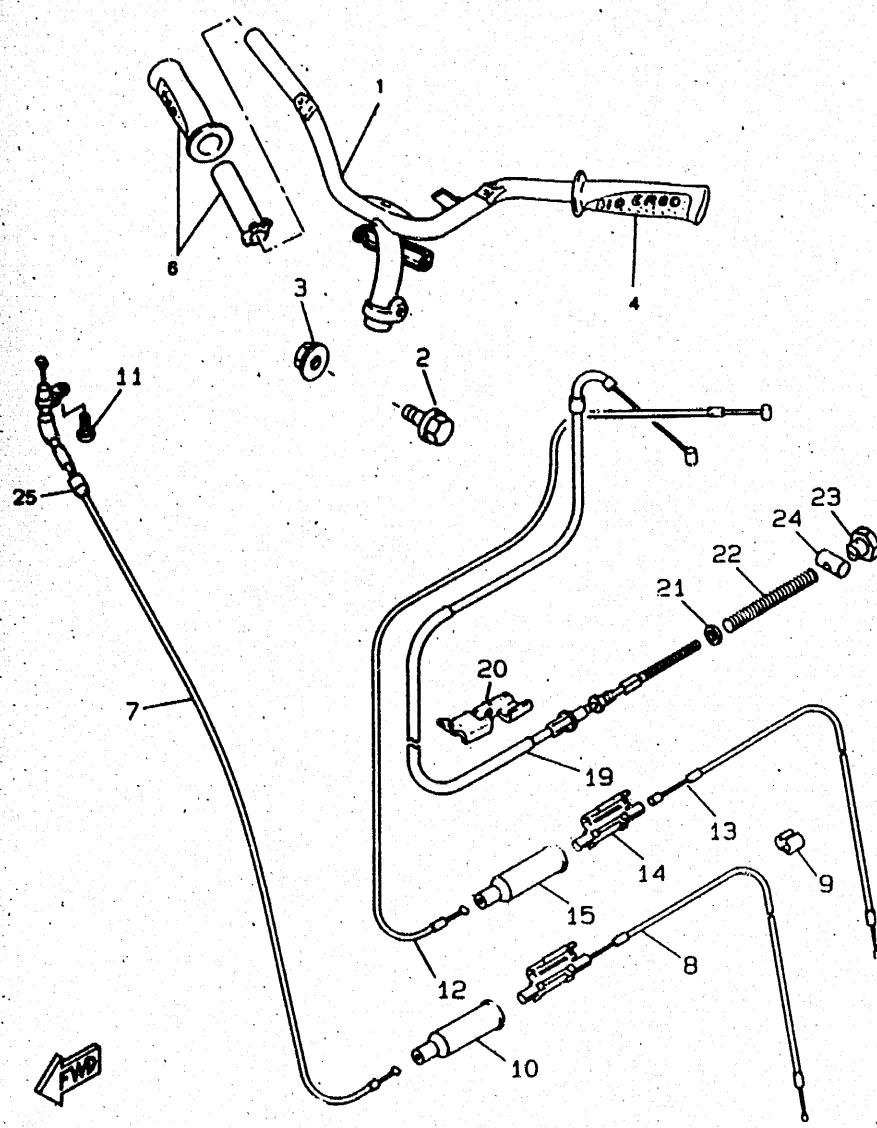

FIG 23 STEERING HANDLE. CABLE

REF	PART.N°	DESCRIPTION	QTY	REMARKS
1	4SB-F6110-00	HANDLE COMP.	1	
2	90105-10036	BOLT, WASHER BASED	1	
3	95617-10200	BOLT, STUD	1	
4	4SB-F6241-00	GRIP (LEFT)	1	
6	4SB-F6240-00	GRIP ASSY	1	
7	3VL-F6311-01	CABLE, THROTTLE 1	1	
8	3VL-F6312-01	CABLE, THROTTLE 2	1	
9	90468-15009	CLIP	1	
10	3WG-F6329-00	CAP, RUBBER	1	
11	98517-05010	SCREW	1	
12	4SB-F6331-00	CABLE, STARTER 1	1	
13	3VL-F6334-02	CABLE, STARTER 2	1	
14	3VL-F6261-00	CONNECTOR, CABLE	1	
15	3WG-F6329-00	CAP, RUBBER	1	
19	4SB-F6351-00	CABLE, BRAKE	1	
20	4SB-F6475-00	HOLDER	1	
21	90202-08175	WASHER, PLATE	1	
22	90501-122E1	SPRING, COMPRESSION	1	
23	90179-06411	NUT	1	
24	90249-12008	PIN	1	
25	3VL-F6262-00	CAP, CABLE CONNECTOR	2	

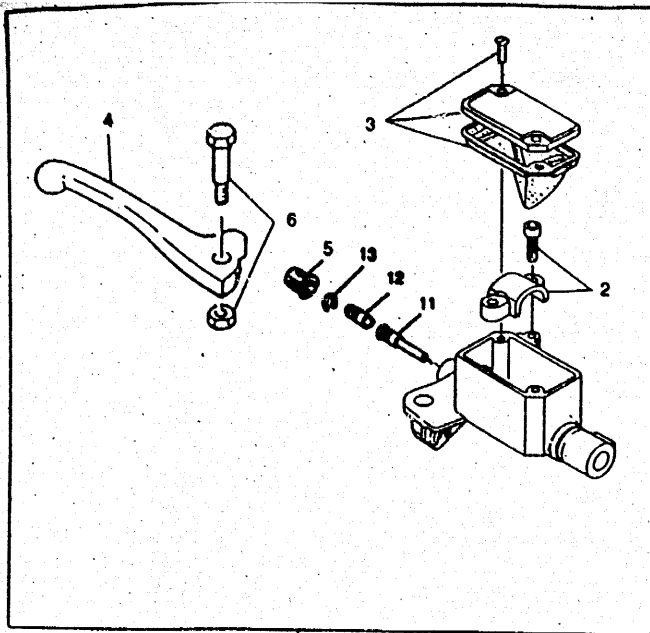
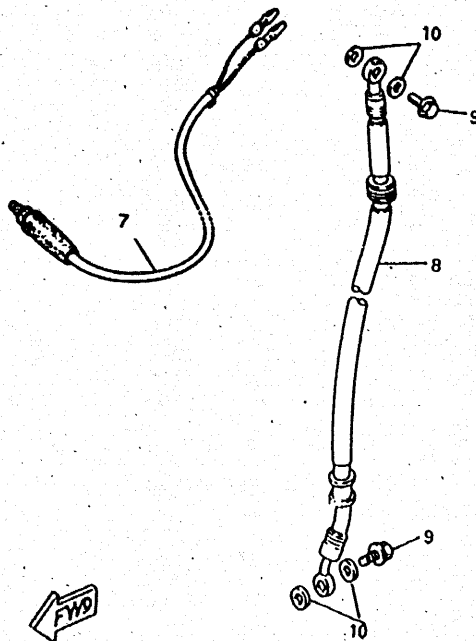

FIG 24 FRONT MASTER CYLINDER

REF	PART.N°	DESCRIPTION	QTY	REMARKS
1	4TD-F583T-01	MASTER CYLINDER ASSY	1	
2	4TD-F5867-00	.BRACKET, MASTER CYLINDER	1	
3	4TD-F5852-00	.CAP, RESERVOIR	1	
4	4TD-H3922-00	.LEVER 2	1	
5	4TD-F6339-00	.BOOT	1	
6	4TD-H3945-00	.BOLT, LEVER	1	
7	5AD-H3980-00	FRONT STOP SWITCH ASSY	1	
8	4SB-F5872-01	HOSE, BRAKE 1	1	
9	90401-10159	BOLT, UNION	2	
10	90201-10118	WASHER, PLAIN	4	
11	4TD-F5856-00	.ROD PUSH	1	
12	4TD-F5924-00	.STOPPER	1	
13	4TD-F5925-00	.CLIP	1	
		NOT ILLUSTRED		
	4VV-F5870-00	.PISTON KIT	1	



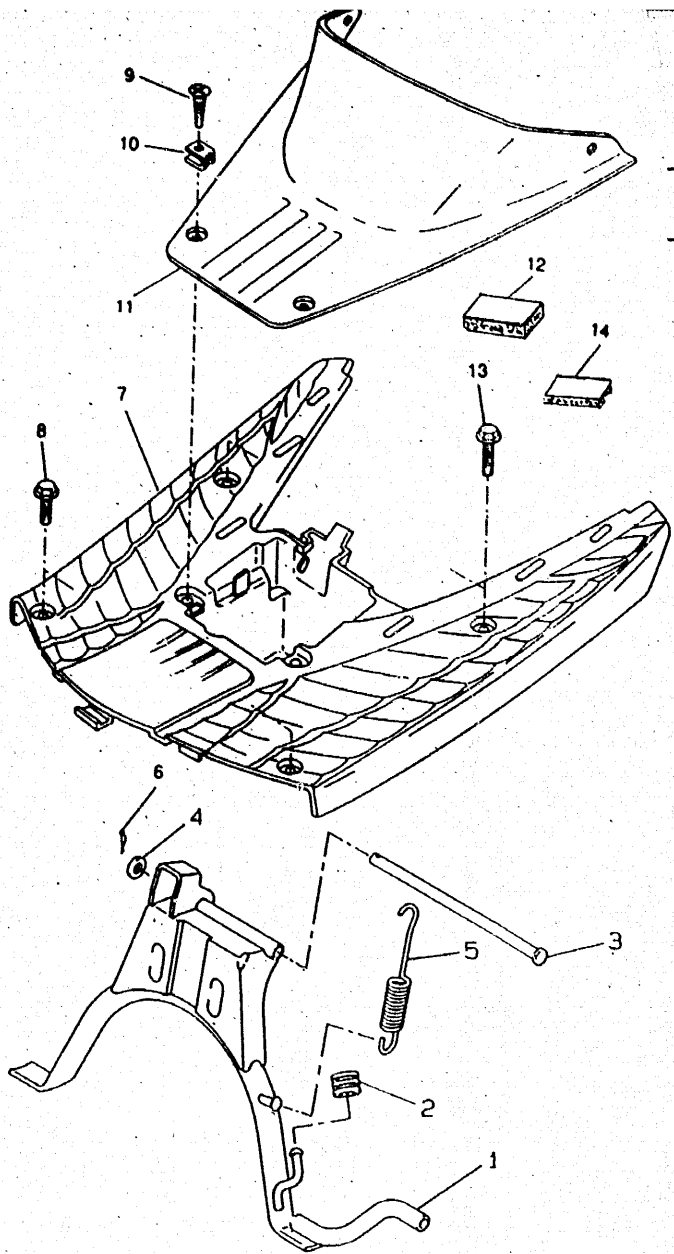

FIG 25 STAND. FOOTREST

REF	PART.N°	DESCRIPTION	QTY	REMARKS
1	4SB-F7111-00	STAND, MAIN	1	UR BLACK
2	90387-076V1	COLLAR	1	
3	4SB-F7112-00	SHAFT, MAIN STAND	1	
4	90202-10120	WASHER, PLATE	1	
5	90536-29280	SPRING	1	
6	90468-12006	CLIP	1	
7	4SB-F7481-00	BOARD, FOOTREST	1	UR BLACK
8	4SB-F7117-10	BOLT	2	
9	97707-50016	SCREW, TAPPING	4	
10	90183-05042	NUT, SPRING	2	
11	4SB-F1741-00	COVER, SIDE 4	1	UR BLACK
12	4SB-F174X-00	DAMPER	1	
13	4SB-F7117-00	BOLT	2	
14	4SB-F174X-10	DAMPER	2	



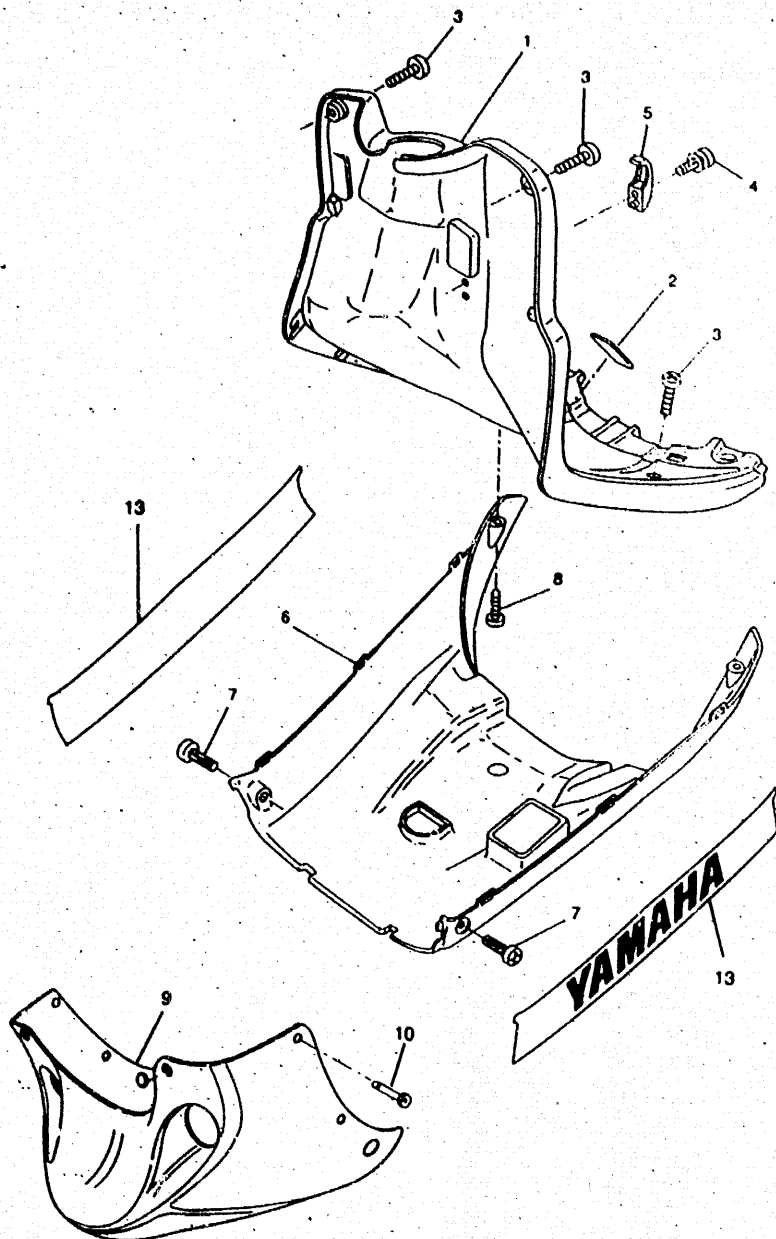

FIG 26 LEG SHIELD

REF	PART.N°	DESCRIPTION	QTY	REMARKS
1	4SB-F8312-01	LEG SHIELD 2	1	UR BLACK
2	3WV-F8349-10	CAP	1	
3	97707-50016	SCREW, TAPPING	4	
4	90154-06X02	SCREW, BINDING	1	
5	4SB-F1398-00	HANGER, HELMET	1	
6	4SB-F8385-00	COVER, LOWER	1	UR BL2
	4SB-F8385-90	COVER, LOWER	1	UR VYRS1
7	4SB-F8382-00	SCREW, SPECIAL	2	
8	97707-50016	SCREW, TAPPING	2	
9	4UP-F842M-01	COVER 1	1	UR BL2
	4UP-F842M-71	COVER 1	1	UR VYRS1
10	4UP-F1128-00	BLIND	6	
13	4UP-F839H-00	EMBLEM 1	2	UR VYRS1
	4UP-F839H-30	EMBLEM 1	2	UR BL2



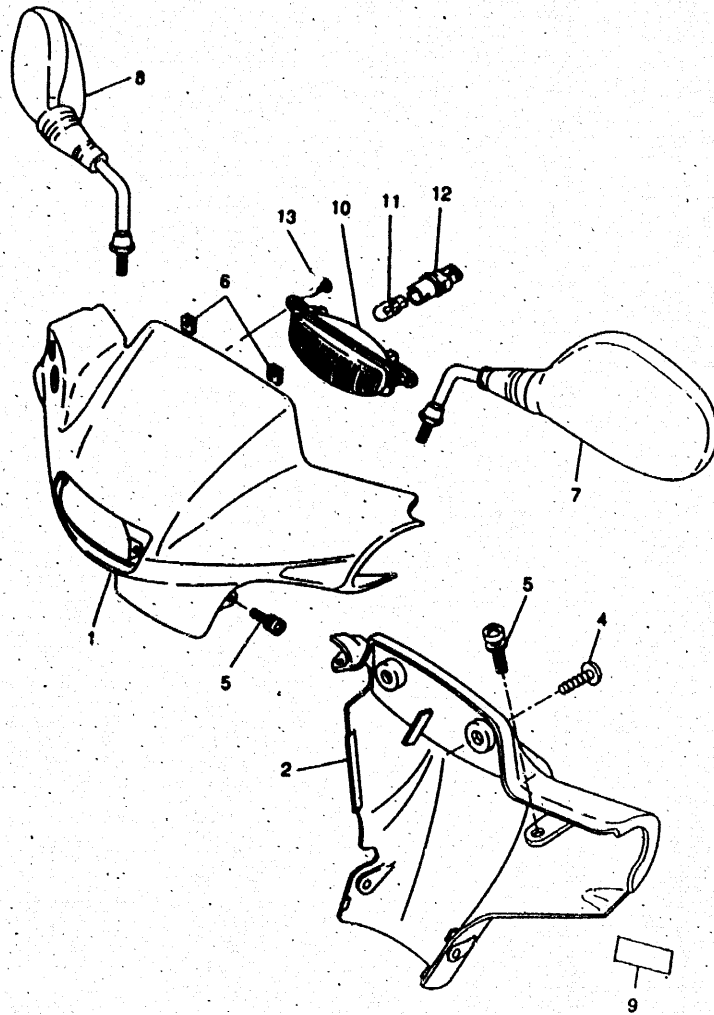

FIG 27 CJWLING 1

REF	PART.N°	DESCRIPTION	QTY	REMARKS
1	4SB-F6143-00-4B	COVER, HANDLEBAR UPPER 1	1	UR BLACK 2
	4SB-F6143-00-PC	COVER, HANDLEBAR UPPER 1	1	UR VIVID YELLOWISH RED SOLID1
2	4SB-F6145-00	COVER, HANDLEBAR UPPER 2	1	UR YAMAHA BLACK
4	97707-50016	SCREW, TAPPING	2	
5	90159-05134	SCREW, WITH WASHER	4	
6	90183-05042	NUT, SPRING	2	
7	4SB-F6280-00	MIRROR (LEFT)	1	
8	4SB-F6290-00	MIRROR (RIGHT)	1	
9	4CU-F1568-10	LABEL, WARNING	1	
10	4SB-H3530-00	PILOT LIGHT ASSY	1	
11	3WW-H4347-00	:BULB LICENCE LIGHT	1	
12	3UP-H4346-00	:SOCKET, PILOT LIGHT	1	
13	97707-50016	SCREW, TAPPING	2	

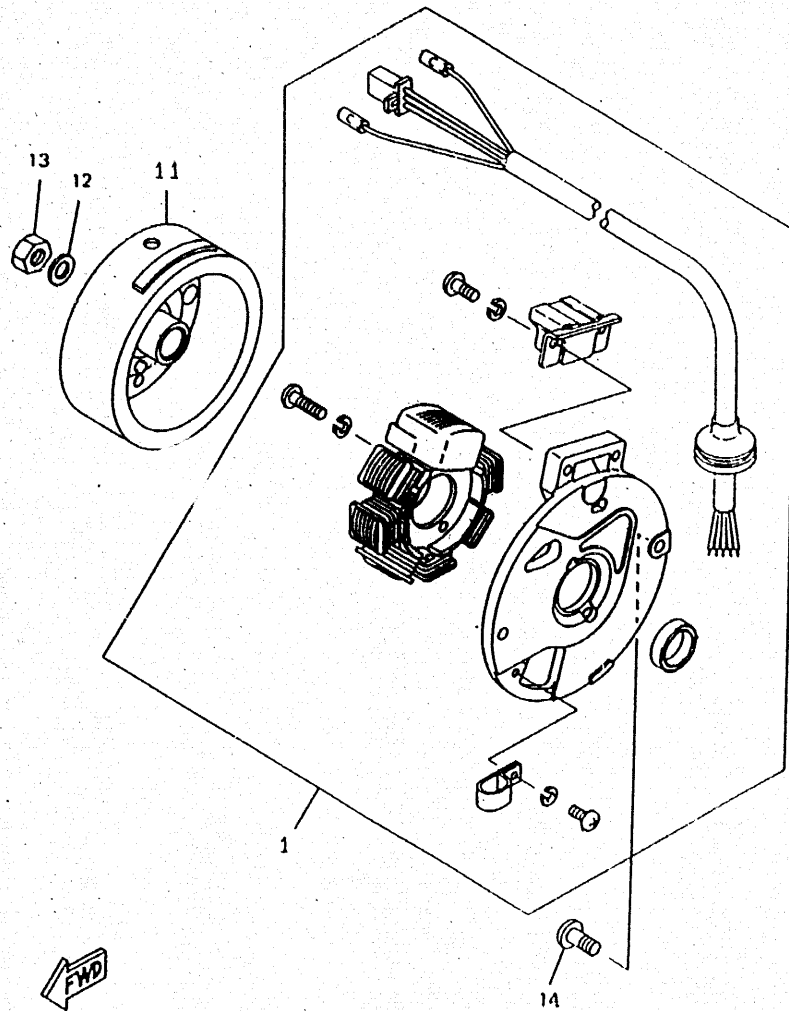

FIG 28 GENERATOR

REF	PART.N°	DESCRIPTION	QTY	REMARKS
1	4SB-85560-00	BASE ASSY	1	
11	2JA-85550-00	ROTOR ASSY	1	
12	90201-10X02	WASHER, PLAIN	1	
13	90170-10219	NUT	1	
14	98507-06016	SCREW	2	

# CONTENTS

## ENGINE

CYLINDER .....	B2
CRANKSHAFT-PISTON .....	B3
AIR SHROUD-FAN .....	B4
OIL PUMP .....	B5
INTAKE .....	B6
CARBURETOR .....	B7
EXHAUST .....	B8
CRANKCASE .....	B9
STARTER.....	B10
CLUTCH.....	B11
TRANSMISSION .....	B12

## CHASSIS

FRAME.....	B13
FENDER.....	B14
SIDE COVER .....	B15
OIL TANK.....	C2
REAR SUSPENSION .....	C3
FRONT FORK .....	C4

FUEL TANK .....	C5
SEAT CARRIER.....	C6
FRONT WHEEL .....	C7
FRONT BRAKE CALIPER .....	C8
REAR WHEEL .....	C9
STEERING-HANDLE-CABLE .....	C10
FRONT MASTER CYLINDER .....	C11
STAND FOOTREST .....	C12
LEG SHIELD .....	C13
COWLING .....	C14
GENERATOR.....	C15
FLASHER LIGHT .....	D2
METER.....	D3
HEADLIGHT.....	D4
TAILLIGHT .....	D5
HANDLE-SWITCH LEVER .....	D6
ELECTRICAL 1 .....	D7
ELECTRICAL 2 .....	D8
NUMERICAL INDEX .....	M1 - M2

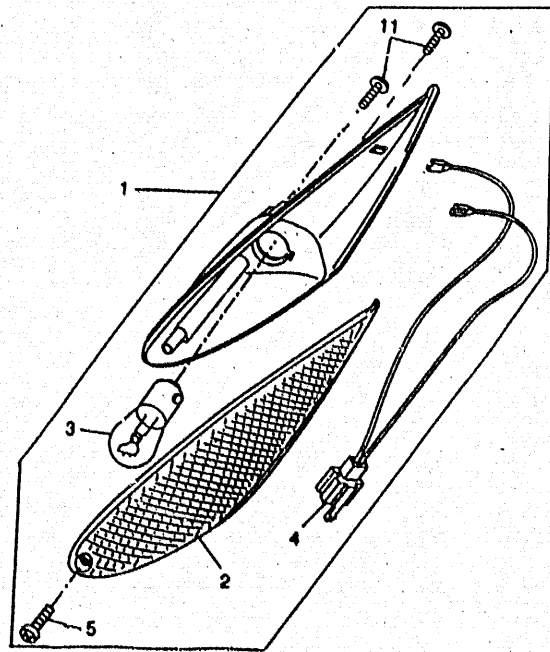
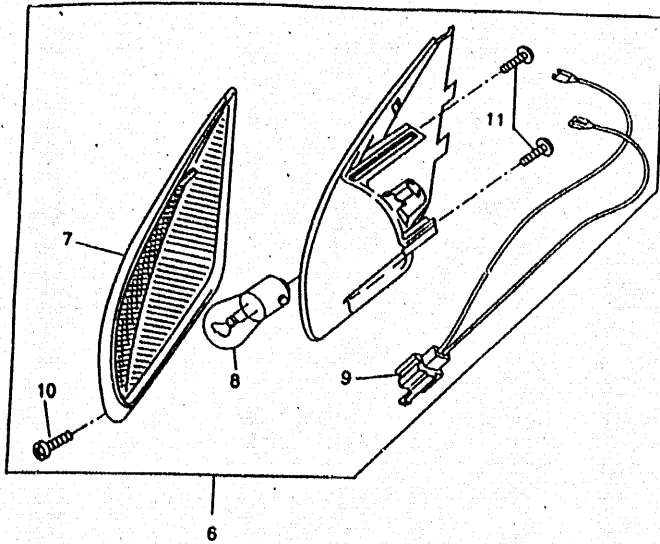

FWD

FIG 29 FLASHER LIGHT

REF	PART.N°	DESCRIPTION	QTY	REMARKS
1	4SB-H3310-00	FRONT FLASHER LIGHT ASSY 1	1	
2	4SB-H3312-00	LENS, FLASHER	1	
3	NH7-H3311-00-01	BULB 12V.21W.	1	
4	4KH-H331N-00	WIRE FLASHER 1	1	
5	4KH-H3333-00	SCREW, LENS FITTING	1	
6	4SB-H3320-00	FRONT FLASHER LIGHT ASSY 2	1	
7	4SB-H3322-00	LENS, FLASHER 2	1	
8	NH7-H3311-00-01	BULB 12V.21W.	1	
9	4KH-H332N-00	WIRE FLASHER 2	1	
10	4KH-H3333-00	SCREW, LENS FITTING	1	
11	97707-50016	SCREW, TAPPING	4	

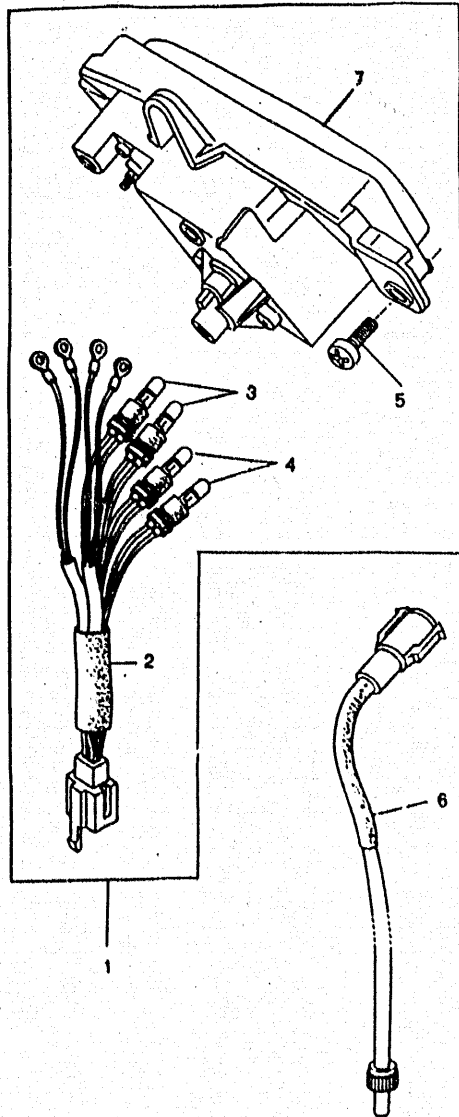

FIG 30 METER

REF	PART.N°	DESCRIPTION	QTY	REMARKS
1	4UP-H3510-00	SPEEDOMETER ASSY	1	
2	4SB-H3509-00	.SOCKET CORD ASSY	1	
3	4SB-H4347-00	.BULB LICENCE LIGHT	2	
4	NJ9-H4744-00-01	.BULB	2	
5	97707-50020	SCREW, TAPPING	2	
6	4SB-H3550-01	SPEEDOMETER CABLE ASSY	1	
7	4SB-H353K-00	.GLASS PLATE	1	

FWD

D3

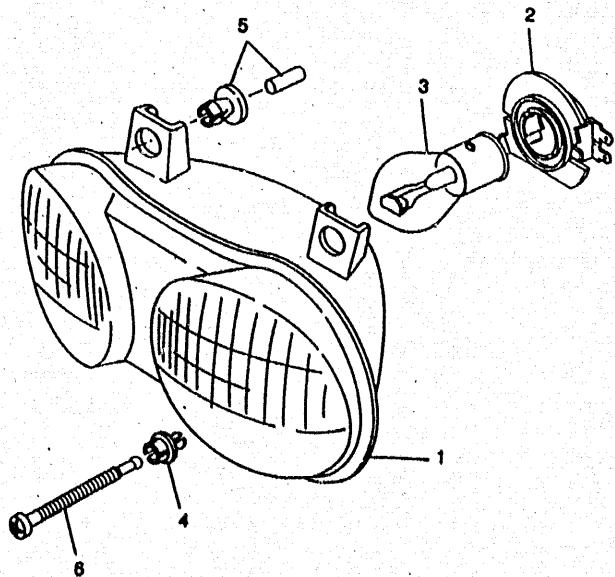

FIG 31 HEADLIGHT

REF	PART.N°	DESCRIPTION	QTY	REMARKS
1	4SB-H4320-00	LENS ASSY	1	
2	4SB-H4146-00	.SOCKET, PILOT LIGHT	1	
3	4SB-H4314-00	.BULB, HEADLIGHT	1	
4	4SB-H4387-00	.HOLDER	1	
5	3VL-H4316-00	NUT, BODY FITTING	2	
6	4SB-H4337-00	BOLT, SPECIAL	1	

← FWD

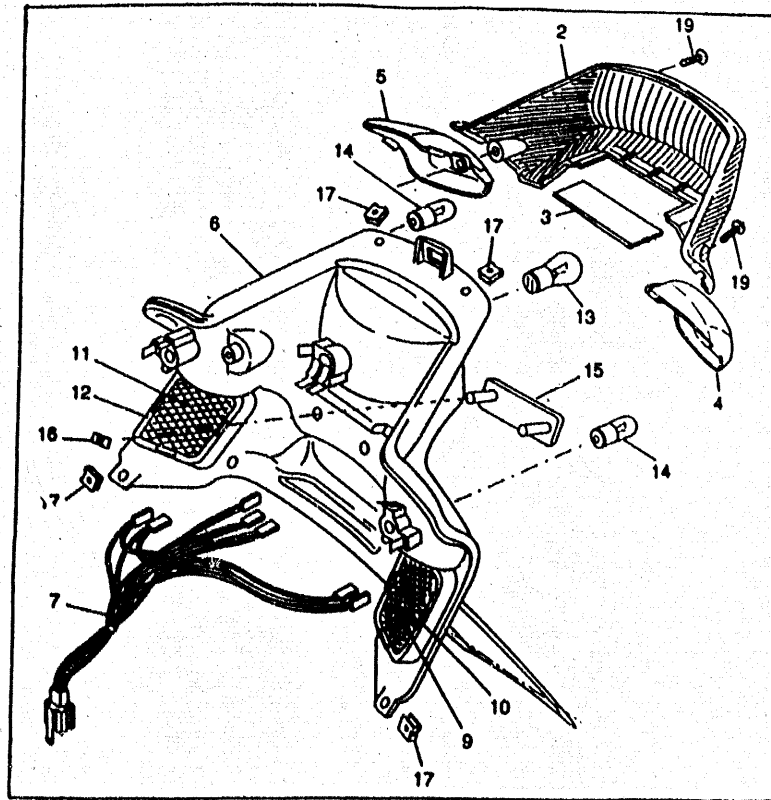
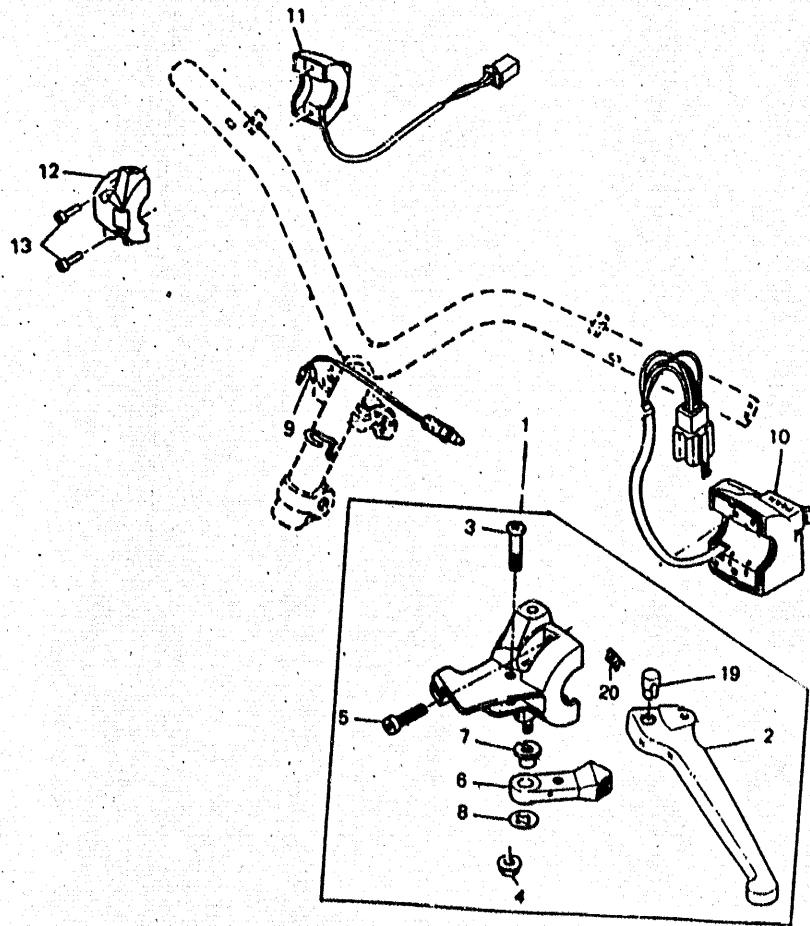

FIG 32 TAILLIGHT

REF	PART.N°	DESCRIPTION	QTY	REMARKS
1	4SB-H4700-00	TAILLIGHT ASSY	1	
2	4SB-H4721-00	.LENS, TAILLIGHT	1	
3	4SB-H4743-00	.LENS, LICENCE LIGHT	1	
4	4SB-H3332-00	.LENS, FLASHER 1	1	
5	4SB-H3342-00	.LENS, FLASHER 2	1	
6	4SB-H4711-00	.BASE, TAILLIGHT	1	
7	4SB-H4717-00	.CORD, TAILLIGHT	1	
8	4SB-H4374-00	.CLIP	2	
9	4SB-H336E-00	.PLATE, ARMATURE 1	1	
10	4SB-H336T-00	.HOLDER, 1	1	
11	4SB-H336F-00	.PLATE, ARMATURE 2	1	
12	4SB-H336U-00	.HOLDER, 2	1	
13	3HL-H4635-00	.BULB	1	
14	NDH-H3311-00-01	.BULB	1	
15	4SB-H5130-00	.REAR REFLECTOR ASSY	1	
16	90468-04814	.CLIP	2	
17	90183-05042	NUT, SPRING	4	
18	90119-08213	BOLT, WITH WASHER	2	
19	4SB-H4724-00	.SCREW, LENS FITTING	2	

FW

FIG 33 HANDLE SWITCH, LEVER



REF	PART.N°	DESCRIPTION	QTY	REMARKS
1	4SB-H2910-01	LEVER HOLDER ASSY (LEFT)	1	
2	4SB-H3912-00	.LEVER 1	1	
3	3VL-H3915-00	.SCREW, LEVER FITTING	1	
4	3VL-H3916-00	.NUT, LEVER FITTING	1	
5	3VL-H3945 00	.BOLT, LEVER	2	
6	4SB-H3941-00	.LEVER, STARTER	1	
7	3VL-H3982-00	.COLLAR, DECOMPRESSIO	1	
8	3VL-H3943-00	.WASHER, STARTER	1	
9	5AD-H3980-00	FRONT STOP SWITCH ASSY	1	
10	4CA-H3976-11	SWITCH, HANDLE 1	1	
11	4KH-H3975-11	SWITCH, HANDLE 2	1	
12	4CU-H3987-01	CASE, SWITCH LOWER	1	
13	3VL-H3945-00	BOLT, LEVER	2	
19	3VL-F636A-00	.END, WIRE 1	1	
20	4KH-H3962-00	.SPRING	1	





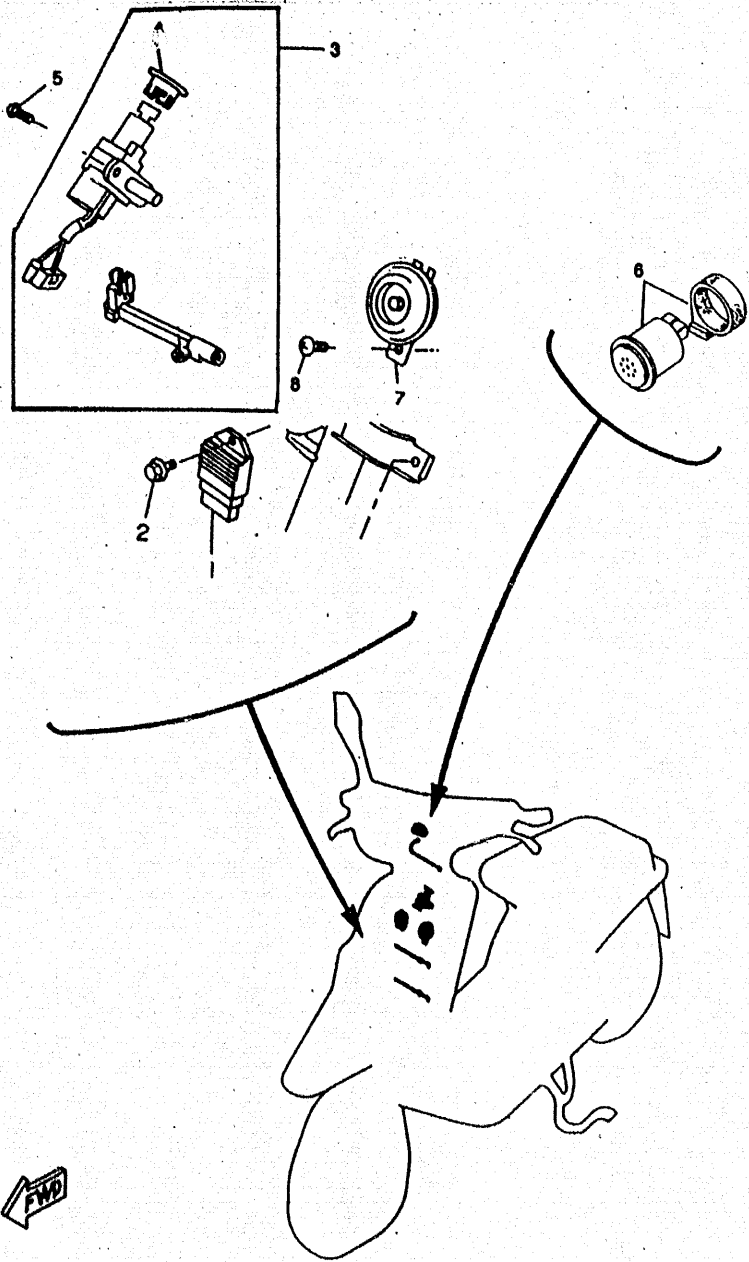

FIG 34 ELECTRICAL1

REF	PART.N°	DESCRIPTION	QTY	REMARKS
1	4VV-H1960-00	RECTIFIER & REGULATOR ASSY	1	
2	90105-06696	BOLT, FLANGE	1	
3	4SB-H2021-02	KEY SET	1	
4	4VV-H2532-00	CAP	1	
5	90109-06851	BOLT	2	
6	4TD-H3350-00	FLASHER RELAY ASSY	1	
7	4CU-H3371-00	HORN	1	
8	98507-06010	SCREW	1	

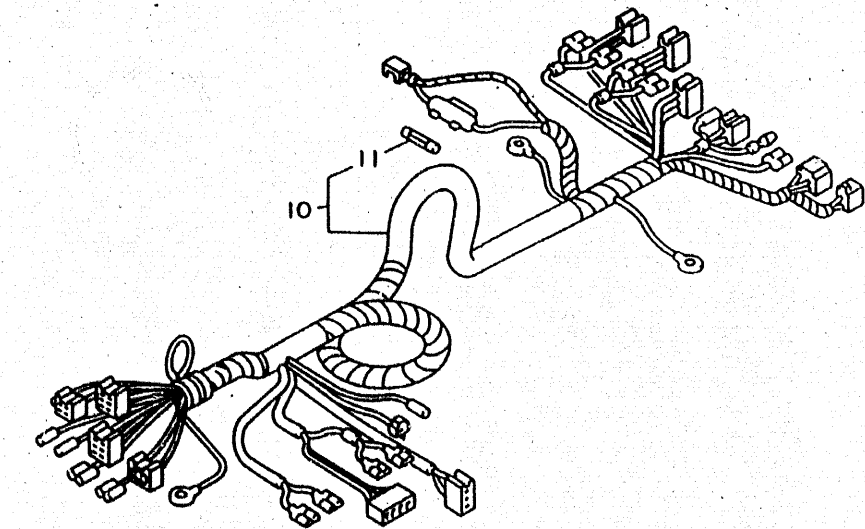
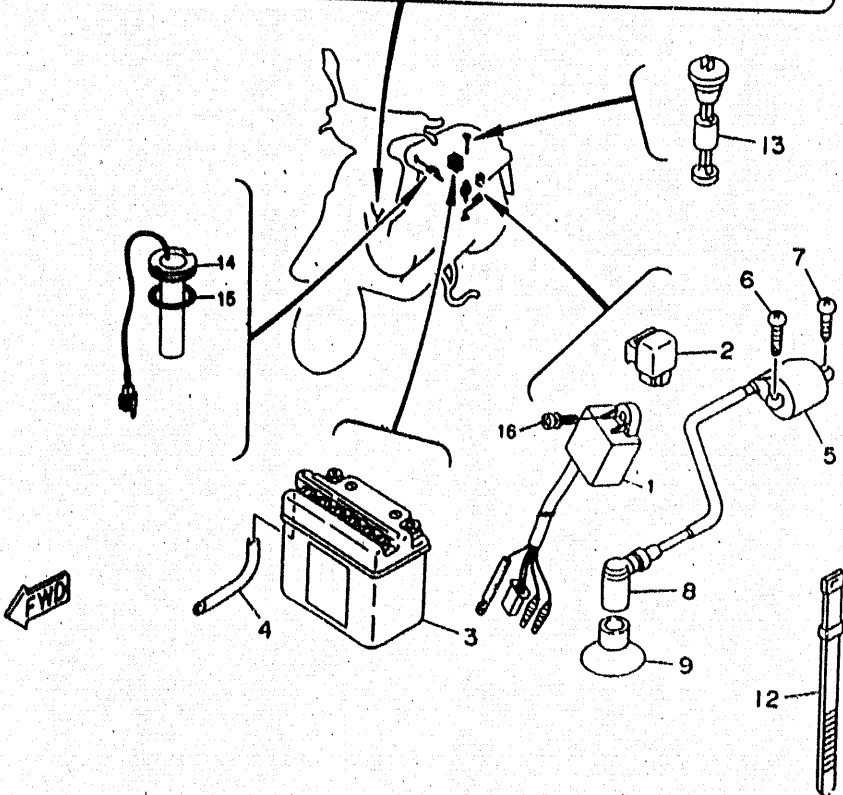

FIG 35 ELECTRICAL2

REF	PART.N°	DESCRIPTION	QTY	REMARKS
1	3KJ-85540-10	C.D.I. UNIT ASSY	1	
2	29U-81950-93	RELAY ASSY	1	
3	4CU-H2110-10	BATTERY ASSY	1	FIAMM
	38E-82110-09	BATTERY ASSY	1	YUSA
5	3KJ-82310-10	IGNITION COIL ASSY	1	
6	97017-06018	BOLT	1	
7	90153-06034	SCREW, HEXAGON	1	
8	3WG-H2370-10	PLUG CAP ASSY	1	
9	3WG-H2372-00	SEAL, PLUG CAP	1	
10	4SB-H2590-00	WIRE HARNESS ASSY	1	
11	27V-82151-00	FUSE	1	
12	4KH-H3936-00	BAND, SWITCH CORD	2	
13	4SB-H5720-00	OIL LEVEL GAUGE ASSY	1	
14	4SB-H5752-00	SENDER UNIT ASSY, FUEL METER	1	
15	4SB-H5753-03	GASKET, SENDER UNIT	1	
16	90154-06X02	SCREW, BINDING	1	



← FWD

# NUMERICAL INDEX

4SB- 13100-00	B5	3VL- E3178-00	B5	3VL- E5411-00	B9	4WK- F1569-00	B14	4SB- F4312-00	C5	3VL- F6312-01	C10
3AA- 13124-00	B5	3VL- E3555-00	B6	3VL- E5421-00	B9	4WK- F1569-10	B14	4SB- F4318-00	C6	3WG- F6329-00	C10
1YU- 13185-00	B5	3VL- E3610-00	B6	3VL- E5451-00	B9	4WK- F1579-00	B14	4SB- F4335-00	C5	3WG- F6329-00	C10
1YU- 13187-00	B5	4SB- E4103-01	B7	3VL- E5461-00	B9	4WK- F1579-10	B14	4SB- F4451-01	C5	4SB- F6329-00	B7
1YU- 13418-00	B5	4SB- E4104-00	B7	3VL- E5462-00	B9	4SB- F1629-01	B14	4SB- F4500-00	C5	4SB- F6331-00	C10
1YU- 13473-00	B5	4SB- E4115-00	B7	3VL- E5528-00	B10	4UP- F1631-00	C6	4MJ- F4610-00	C5	3VL- F6334-02	C10
1YU- 13516-00	B5	4SB- E4124-00	B7	3VL- E5532-00	B10	4SB- F1711-00	B15	4CU- F4726-00	C6	4TD- F6339-00	C11
1YU- 13577-00	B5	4SB- E4133-01	B7	3VL- E5620-01	B10	4SB- F171E-00-4B	B15	4SB- F4730-00	C6	4SB- F6351-00	C10
4KN- 13621-00	B6	4SB- E4134-00	B7	4SB- E5631-00	B10	4SB- F171E-00-PB	B15	4SB- F4731-00	C6	3VL- F636A-00	D6
3HK- 14613-00	B8	4SB- E4137-00	B7	4SB- E5650-00	B10	4SB- F1721-00-4B	B15	4SB- F473R-01	C6	4SB- F6475-00	C10
2JA- 14737-00	B8	4SB- E4148-01	B7	3VL- E5659-00	B9	4SB- F1721-00-PB	B15	4SB- F473T-00	C6	4SB- F7111-00	C12
4FB- 14766-00	B8	5BR- E4161-00	B7	3VL- E5669-00	B10	4SB- F1731-00-4B	B15	3VL- F4741-00	C6	4SB- F7112-00	C12
3HK- 14766-01	B8	4SB- E4216-00	B7	3VL- E5673-00	B10	4SB- F1731-00-PB	B15	3VL- F4741-10	C6	4SB- F7117-00	C12
3AA- 15513-00	B10	4SB- E4216-10	B7	3VL- E6111-00	B11	4WK- F173E-00	B15	4SB- F475M-00	C6	4SB- F7117-10	C12
3VL- 15570-00	B10	4SB- E4283-01	B7	5BR- E6611-00	B11	4WK- F173E-10	B15	4UP- F4812-01-4B	C6	4SB- F7452-00	B13
3ES- 15601-01	B10	4SB- E4301-01	B7	5BR- E6620-00	B11	4WK- F173F-00	B15	4UP- F4812-01-P1	C6	4SB- F7481-00	C12
3KJ- 15657-00	B11	4SB- E4312-02	B7	5BR- E6626-00	B11	4WK- F173F-10	B15	4SB- F5117-00	C7	4SB- F8312-01	C13
3AA- 17641-00	B11	4SB- E4318-00	B7	4SB- E7410-00	B12	4SB- F1741-00	C12	4VV- F5138-00	C7	3WV- F8349-10	C13
2T4- 2139X-00	B13	5BR- E4325-00	B7	4SB- E7420-00	B12	4SB- F174X-00	C12	4UP- F5168-30	C7	4SB- F8382-00	C13
2T4- 21481-01	B13	4SB- E4331-02	B7	3VL- E7611-00	B11	4SB- F174X-10	C2	4UP- F5168-40	C7	4SB- F8385-00	C13
25G- 21535-00	C2	4SB- E4335-00	B7	4CU- E7620-00	B11	4SB- F174X-10	C5	3VL- F5170-10	C7	4SB- F8385-90	C13
25G- 21535-00	C5	5BR- E4336-00	B7	3VL- E7623-00	B11	4SB- F174X-10	C12	3VL- F5170-10	C9	4UP- F839H-00	C13
2N3- 21771-01	C2	4SB- E4341-00	B7	4KH- E7632-00	B11	4SB- F1751-00	C2	3VL- F5182-00	C9	4UP- F839H-30	C13
4B6- 22141-01	C7	4SB- E4342-00	B7	3VL- E7653-00	B11	4SB- F2210-00	C3	4VV- F5190-00	C7	4UP- F842M-01	C13
164- 22216-00	B9	4SB- E4343-00	B7	4SB- E7654-00	B11	4UP- F3100-01	C4	3VL- F5326-00	C9	4UP- F842M-71	C13
3Y6- 2533A-01	C9	4SB- E4344-01	B7	5BR- E7660-00	B11	4TD- F3110-00	C4	4UP- F5338-30	C9	4SB- H1800-00	B10
3AA- 25351-00	C9	4SB- E4357-00	B7	5BR- E7664-00	B11	4TD- F3111-00	C4	4UP- F5338-40	C9	4VV- H1960-00	D7
4SB- 2582T-00	C8	5BR- E4358-00	B7	5BR- E7671-00	B11	4TD- F3112-00	C4	3VL- F5355-00	C9	4SB- H2021-02	C6
29U- 81950-93	D8	4SB- E4368-01	B7	5BR- E7684-00	B11	4UP- F3126-00	C4	3VL- F5384-00	C9	4SB- H2021-02	D7
38E- 82110-09	D8	5BR- E4369-00	B7	4YB- F1110-12	B13	4UP- F3136-00	C4	4CU- F580T-20	C8	4CU- H2110-10	D8
27V- 82151-00	D8	4SB- E4371-00	B7	4UP- F1128-00	C13	4TD- F3141-00	C4	4CU- F5811-20	C8	4SB- H2141-00	C2
3KJ- 8231Q-10	D8	4SB- E4377-00	B7	4UP- F1165-00	C6	4TD- F3144-00	C4	4CU- F5824-00	C8	3WG- H2370-10	D8
3KJ- 85540-10	D8	4SB- E4381-00	B7	4UP- F1182-00	B13	4TD- F3145-00	C4	4CU- F5825-00	C8	3WG- H2372-00	D8
2JA- 85550-00	C15	4SB- E4385-00	B7	4SB- F1232-00	B13	4TD- F3147-00	C4	4TD- F583T-01	C11	4VV- H2532-00	D7
4SB- 85560-00	C15	4SB- E4386-00	B7	4SB- F1238-00	B9	4TD- F3153-00	C4	4TD- F5852-00	C11	4SB- H2590-00	D8
4SB- E1111-00	B2	4SB- E4392-00	B7	4SB- F1398-00	C13	4TD- F3154-00	C4	4TD- F5856-00	C11	4SB- H2910-01	D6
3VL- E1181-00	B2	3VL- E4410-01	B6	3VL- F1410-11	B13	4TD- F3156-00	C4	4TD- F5867-00	C11	4SB- H3310-00	D2
4SB- E1311-00	B2	3VL- E4429-00	B6	4SB- F1511-00-4B	B14	4CU- F3165-00	C4	4VV- F5870-00	C11	4SB- H3311-00-01	D5
3VL- E1351-00	B2	3VL- E4437-00	B6	4SB- F1511-00-PB	B14	4TD- F3181-00	C4	4SB- F5872-01	C11	NH7- H3311-00-01	D2
3VL- E1400-10	B3	3VL- E4451-00	B6	4UP- F1519-00	B14	4TD- F3183-00	C4	4CU- F5919-00	C8	NH7- H3311-00-01	D2
4SB- E1603-00	B2	3VL- E4452-00	B6	4UP- F1519-60	B14	4TD- F3340-01	C4	4TD- F5924-00	C11	4SB- H3312-00	D2
4SB- E1603-00	B3	3VL- E4453-01	B6	4UP- F152A-10	B14	4TD- F3394-00	C4	4TD- F5925-00	C11	4KH- H331N-00	D2
4SB- E1605-00	B3	3VL- E4565-00	B6	4UP- F152A-10	B15	4SB- F3411-01	C4	4SB- F6110-00	C10	4SB- H3320-00	D2
4SB- E1631-00	B2	4SB- E4610-00	B8	4UP- F152A-20	B14	4SB- F3412-00	C4	4SB- F6143-00-4B	C14	4SB- H3322-00	D2
4SB- E1631-00	B3	4SB- E4678-00	B8	4UP- F152A-20	B15	4SB- F3414-00	C4	4SB- F6143-00-PC	C14	4KH- H332N-00	D2
3VL- E1633-00	B2	4SB- E4718-00	B8	4UP- F1531-00	B14	4SB- F3427-01	C4	4SB- F6145-00	C14	4SB- H3332-00	D5
3VL- E1633-00	B3	4SB- E4759-00	B8	4SB- F1552-01	B14	4SB- F3453-01	C4	4SB- F6240-00	C10	4KH- H3333-00	D2
4SB- E1636-00	B3	4SB- E479X-00	B8	4SB- F1553-00	B14	4SB- F3812-00	C4	4SB- F6241-00	C10	4KH- H3333-00	D2
3VL- E2611-00	B4	3VL- E5128-00	B9	4UP- F1556-00-4B	B14	4SB- F4110-00	C5	3VL- F6261-00	C10	4SB- H3342-00	D5
3VL- E2651-00	B4	3VL- E5150-00	B9	4UP- F1556-00-P1	B14	4SB- F414E-00	C2	3VL- F6262-00	C10	4TD- H3350-00	D7
3VL- E2653-00	B4	3VL- E5317-00	B9	4WK- F1565-00	B14	4SB- F414G-00	C5	4SB- F6280-00	C14	4SB- H336E-00	D5
3VL- E2658-00	B4	3VL- E5363-00	B9	4WK- F1565-10	B14	4SB- F4181-00	C5	4SB- F6290-00	C14	4SB- H336F-00	D5
3VL- E2658-00	B4	3VL- E5371-00	B9	4CU- F1568-10	B14	4SB- F4311-01	C5	3VL- F6311-01	C10	4SB- H336T-00	D5

# NUMERICAL INDEX

4SB- H336U-00	D5	90101-06291	C9	90249-12008	C10	93101-20138	B3	98507-05014	B5
4CU- H3371-00	D7	90101-06X01	B10	90267-32801	B13	93102-17342	B11	98507-06010	D7
4SB- H3509-00	D3	90101-10776	C3	90280-03017	B3	93102-20371	B3	98507-06016	C15
4UP- H3510-00	D3	90105-06696	D7	90380-15083	B10	93102-22314	B12	98507-06020	C5
4SB- H3530-00	C14	90105-08121	C3	90387-06023	B4	93104-34832	B11	98507-06020	C6
4SB- H353K-00	D3	90105-10036	C10	90387-06023	B4	93106-20001	C7	98517-05010	C10
4SB- H3550-01	D3	90105-10297	B13	90387-060G7	B8	93210-07540	C9	98517-06012	B9
4SB- H3912-00	D6	90109-063F1	C6	90387-060G7	C5	93210-14104	B9	98517-06012	B10
3VL- H3915-00	D6	90109-06851	D7	90387-061V4	B6	93210-368E7	B11	98517-06020	B4
3VL- H3916-00	D6	90110-06237	B9	90387-076V1	C12	93306-00201	B9	98517-06025	B6
4TD- H3922-00	C11	90110-06237	B9	90387-10079	C7	93306-20006	B11	98904-06016	B8
4KH- H3936-00	D8	90110-06237	B9	90387-135U9	B11	93306-20006	B12	98907-06016	B14
4SB- H3941-00	D6	90110-06240	B9	90387-156U0	B3	93306-20301	B11	99001-05600	B11
3VL- H3943-00	D6	90110-06825	B9	90401-10159	C11	93306-20310	B12	99009-15400	B9
3VL- H3945-00	D6	90110-10223	C8	90430-08206	B9	93306-204X2	B3	99009-15400	B10
3VL- H3945-00	D6	90116-06418	B2	90445-094J4	B5	93306-300Y8	C7	99009-19400	B5
4TD- H3945-00	C11	90119-06044	C2	90445-094J4	C2	93310-210M0	B3	99510-12016	B9
4KH- H3962-00	D6	90119-06052	B14	90446-13311	B9	93310-257R1	B10	99530-10014	B9
4KH- H3975-11	D6	90119-06213	D5	90450-32081	B6	93420-40064	B12	99530-10014	B9
4CA- H3976-11	D6	90153-06022	B4	90465-08122	B9	93450-11120	B2		
5AD- H3980-00	C11	90153-06034	D8	90467-08003	B5	93450-11120	P3		
5AD- H3980-00	D6	90153-06061	B8	90467-09006	C5	93603-12007	B5		
3VL- H3982-00	D6	90154-06X02	C13	90467-12052	C5	94112-128P5	C7		
4CU- H3987-01	D6	90154-06X02	D8	90467-24140	B6	94112-128R9	C7		
4SB- H4146-00	D4	90159-05134	C14	90468-02033	B5	94113-128S0	C9		
4SB- H4314-00	D4	90170-10219	B11	90468-02033	C2	94701-00195	B2		
3VL- H4316-00	D4	90170-10219	C15	90468-04814	D5	95027-08016	C6		
4SB- H4320-00	D4	90170-28860	B11	90468-12006	C12	95617-10100	B13		
4SB- H4337-00	D4	90179-06411	C10	90468-15009	C10	95617-10200	C3		
3UP- H4346-00	C14	90179-10279	B13	90480-12237	B4	95617-10200	C7		
3WW- H4347-00	C14	90179-10609	B11	90480-12237	B4	95617-10200	C10		
4SB- H4347-00	D3	90183-05042	B15	90480-12497	B6	95707-06500	B2		
4SB- H4374-00	D5	90183-05042	C12	90480-12581	B8	95707-06500	C6		
4SB- H4387-00	D4	90183-05042	C14	90480-13398	C5	95817-06010	B14		
3HL- H4535-00	D5	90183-05042	D5	90501-122E1	C10	95817-08016	B9		
4SB- H4700-00	D5	90185-14070	C9	90501-29517	B13	95817-08016	B13		
4SB- H4711-00	D5	90201-065F3	C2	90501-35864	B11	95817-08020	B8		
4SB- H4717-00	D5	90201-065F3	C5	90506-15260	C9	95817-08030	C8		
4SB- H4721-00	D5	90201-08X00	B10	90506-29280	C12	95817-08040	B8		
4SB- H4724-00	D5	90201-10118	C11	90508-32609	B10	97017-06016	D8		
4SB- H4743-00	D5	90201-10X02	C15	91317-06020	B6	97707-50012	B15		
NJ9- H4744-00-01	D3	90201-133M8	B11	91317-06020	B9	97707-50016	B14		
3EC- H5111-00	B14	90201-140G5	B12	91317-06020	B10	97707-50016	B15		
4SB- H5130-00	D5	90201-142M6	C9	91317-06045	B9	97707-50016	C6		
4SB- H5720-00	D8	90201-154E9	B10	92017-08016	B13	97707-50016	C12		
4SB- H5752-00	D8	90201-177G4	C9	92907-06100	C6	97707-50016	C13		
4SB- H5753-03	D8	90201-574L1	B10	92907-06600	B4	97707-50016	C13		
4UP- M5308-00	C9	90202-08175	C10	92907-06600	B6	97707-50016	C14		
4SB- W0001-00	B7	90202-10120	C12	92907-06600	B14	97707-50016	C14		
2JL- W2536-10	C9	90208-10012	B11	92907-06600	C5	97707-50016	D2		
		90208-14047	B12	92907-06600	C6	97707-50020	D3		
		90214-13055	B11	92990-06600	B4	97707-60016	C5		
		90241-10017	C6	92995-06100	B4	97885-06016	B4		